

# SAMPLE

## MANURE SPILL PREVENTION AND CONTROL PLAN ROAD CROSSINGS FOR MANURE APPLICATIONS USING HOSES OR PIPELINES

Location: 2348 250<sup>th</sup> Street

Manure hoses and pipelines located within an area that could affect the road right-of-way will be inspected daily for excessive wear and possible leak sources. Possible leak sources shall be repaired immediately upon discovery and pumping shall cease until the repairs are made. When available, flow meters or pressure meters on the applicator will be utilized to monitor whether a leak or spill is occurring. The road right-of-way will be inspected for evidence of manure spills or leaks twice a day. An adequate supply of spill containment and remediation materials, such as sand bags, absorbents, etc., shall be readily available to this site.

This site is situated such that the area of the manure pumping culvert surface drains from the road right-of-way into the field to the south. The south ditch at the culvert is contained by a dry field entrance on either side of the culvert. The north ditch at the culvert is contained by a dry field entrance on the east side of the culvert and a ditch "high" on the west side of the culvert. It appears that the elevation of the ditch "high" is higher than the top of the backslope at the south end of the culvert. Therefore, if a leak or spill occurred within the road right-of-way, it would be contained within the road right-of-way to the elevation of the top of the backslope at the south end of the culvert and any overflow over that point would flow to the south into a low area on private property. Although the intake located in the north ditch approximately 300' to the west of the manure pumping culvert is isolated from the manure pumping culvert by the ditch "high", it shall be temporarily plugged during manure pumping.

If a rain storm event should occur during manure pumping to the extent that surface runoff starts to pool behind the temporarily plugged intake, manure pumping shall cease and the temporary plug shall be removed until the surface runoff is adequately drained, at which time the intake can be re-plugged and manure pumping may resume.

SITUATIONAL SKETCH

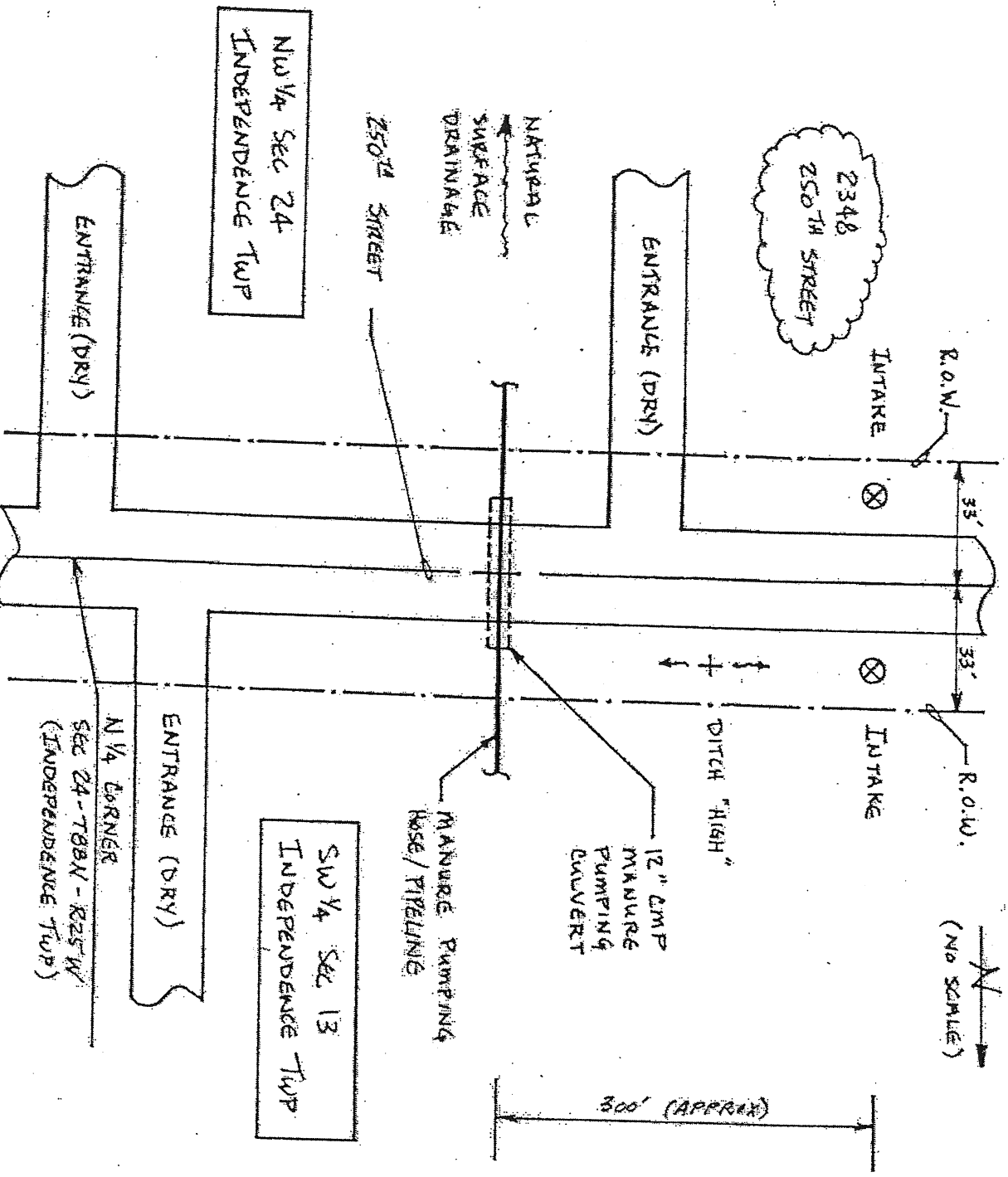

# SAMPLE

## MANURE SPILL PREVENTION AND CONTROL PLAN ROAD CROSSINGS FOR MANURE APPLICATIONS USING HOSES OR PIPELINES

Location: 3077 Inkpaduta Avenue

Manure hoses and pipelines located within an area that could affect the road right-of-way will be inspected daily for excessive wear and possible leak sources. Possible leak sources shall be repaired immediately upon discovery and pumping shall cease until the repairs are made. When available, flow meters or pressure meters on the applicator will be utilized to monitor whether a leak or spill is occurring. The road right-of-way will be inspected for evidence of manure spills or leaks twice a day. An adequate supply of spill containment and remediation materials, such as sand bags, absorbents, etc., shall be readily available to this site.

A stream is located approximately 300' north of the manure pumping culvert. However, during manure pumping, it will be isolated from any potential manure leak or spill by temporarily plugging the south ends of the entrance culverts located north of the manure pumping culvert in both ditches - thus containing the leak or spill from spreading to the north. A potential manure leak or spill will also be contained from spreading south by a dry entrance in the west ditch and a ditch "high" in the east ditch. The ditch "high" in the east ditch is higher than the elevation of the top of the backslope at the west end of the manure culvert. Therefore, if a leak or spill occurred within the road right-of-way, it would be contained within the road right-of-way to the elevation of the top of the backslope at the west end of the manure culvert and any overflow over that point would flow to the west into a low area on private property at the 3077 Inkpaduta Avenue site. No intakes or drainage facilities on the road right-of-way will be compromised by a potential manure spill or leak at this site.

If a rain storm event occurs during manure pumping to the extent that surface runoff starts to pool behind the temporarily-plugged entrance culverts, manure pumping shall cease and the temporary plugs shall be removed until the surface runoff is adequately drained, at which time the entrance culverts can be re-plugged and manure pumping may resume.

