

Bradford Found 7-25-56 ESHC

A IRON PIN REF'D - 1950

B IRON PIN REF'D - 1950

FOUND STONE MIDWAY

BETWEEN FENCES /

Found nail 3.3' north of E of 346 5-7-97

BK 164 pg 163

A Found iron pin 20.9' south of E of 346 5-7-97

BK 164 pg 163

C set 1/2" rebar w/cap 4-16-07. File 2007-0733

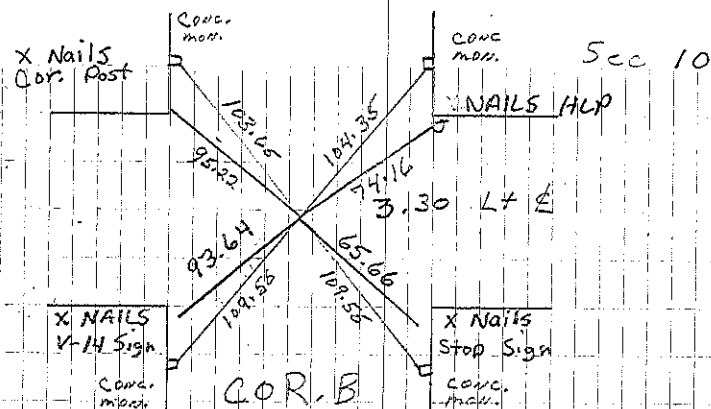

S. Busse Ref'd 5-7-97

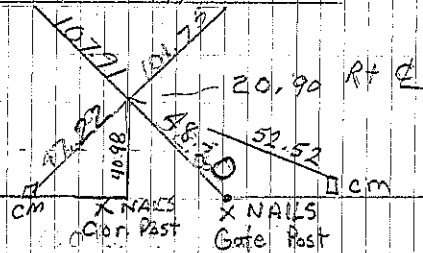

Cor. A

8-1-85 IDOT

S. Busse Ref'd 5-7-97

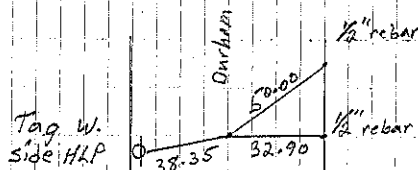

Cor. C

P. Herold set 4-16-07