

SECTION 11 BRADFORD TWP.

A Stone³IP
Ties From Iowa STATE
Highway Comm. 5-2-56
Set Nail in AC 10-12-60

COR. B SET IRON REIN. ROD ON New
GRADE MAY 14, 1949. Found 6-1-59
Set 3/4" rebar w/alum. cap 1.3' N. @ 8-5-05.
File 2005-2163

COR. C SET IRON REIN. ROD ON New
GRADE. MAY 14, 1949
Found PK 1.0' E & in line with fence
west 8-5-05. File 2005-2162

Sec 11

SW 1074
NW 142.11
NE 140.35
SE 108.12

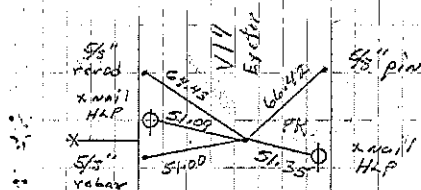
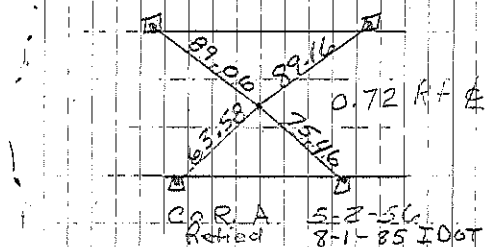

COR. C
SET VALVE IN ASPH.
10-18-60
Set PK in mat 7-1-81
Set PK 10-98 IF
L. Gallentine retied 8-5-05

