

Bradford

B SET IRON PIN

C SET IRON PIN BETWEEN FENCES
24.5' EACH WAY. Found Pin &
RETIED 5-20-57

B Found IRON FENCE POST WITH
TOP ALL CURVED DOWN RETIED
12-9-55. Dug 4'x3' deep hole. Found iron pin
at a 45° angle. Split fences & iron pin appeared on
line N/S. shot distance from S. 1/2 cor. P. & set 1/2 rebar
11-2-06. Did not find fence post. Distance N/S was
from Grading plans CG 27.5 at 26522'. Moved new pin
N. approx. 2'. Set for Const. Only

A Split fences & set spike for Const. 6-22-77.
Found 60d spike 3-4-04. File 2004-0509.

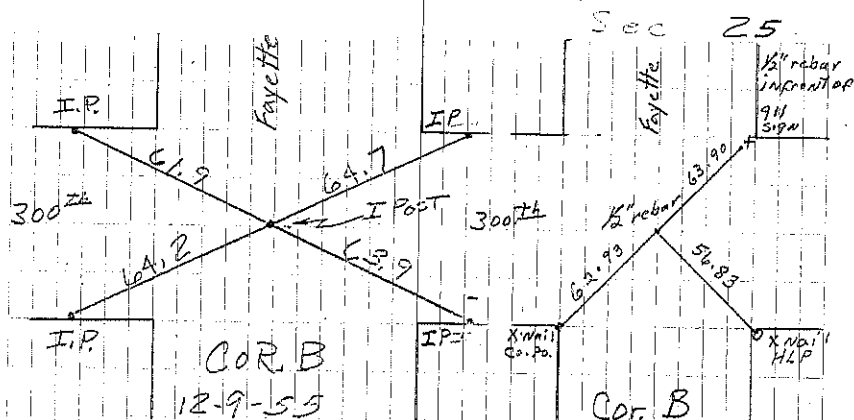

Set 1/2" rebar 11-2-06 JF/MT
For Const. Only

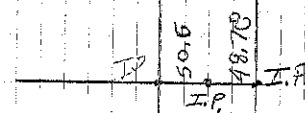

COR. C
5-20-57
Consultant S.P.W./PST

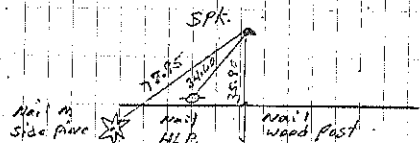

COR. A
L. Erdman found 3-4-04