

Sec 21-95-14

COR B Stone Brick BOLT & Stake 33' From West Post.

COR C Iron Pin 35' From Each Fence

COR C1 Stone Iron Pin 1927 set Stone & Iron Pin  
 Retied 1960 Cleveland & HARK  
 Beginning of COR. B. Sec. 16 The  
 Distance was obtained to COR. C1  
 Sec. 21 and found to be exactly  
 1331.0'. Retied after 1962 grading  
 11-15-62 Duxeman.

Note. See next page for other  
 ties to constr. for Asphalt

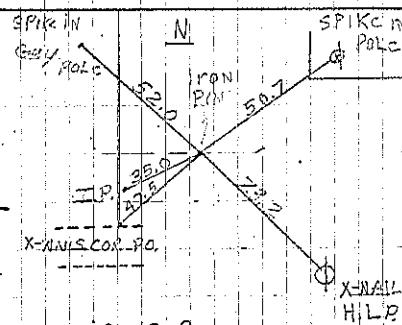
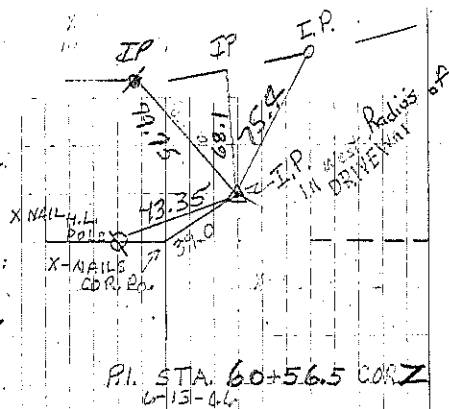
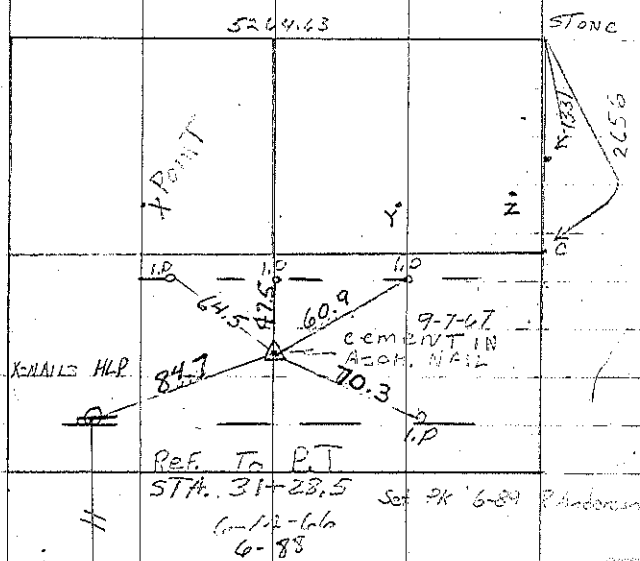

COR. C1  
 Retied 1960  
 Retied 11-15-62

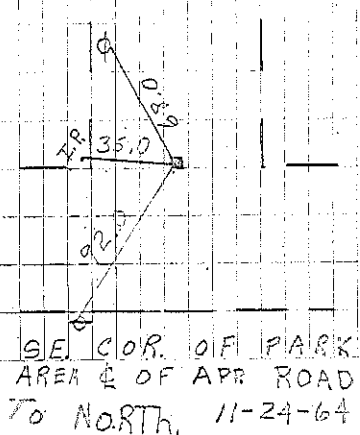

Chickasaw

Retied 6-10-64

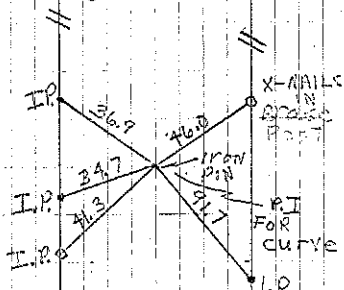

POINT X  
 Set PL 10-30-63

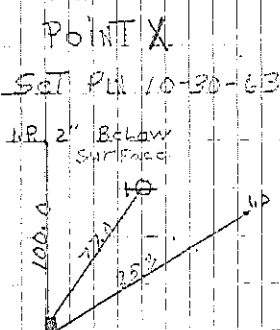

SE COR. OF PARK  
 AREA FALLS IN BTM.  
 OF DITCH. 11-23-64

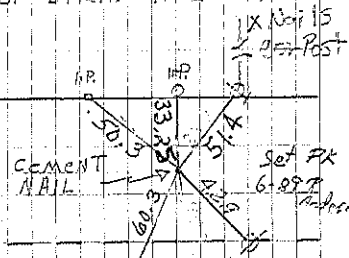

COR. Y  
 9-7-67 X Nail  
 R.C.A. 6-88 in Gate C  
 Sta 54+00

Chickasaw

SE COR. HOUSE Foundation

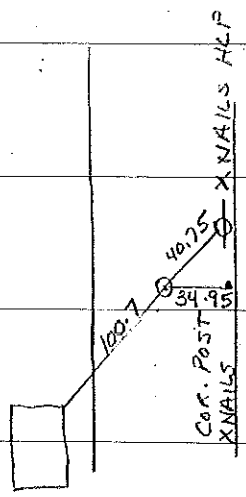

PC STA 58+07.3

6-88 got good reading w/ Metal Locator set new ties did not measure from 101 JFM  
Set PK nail in new mat 7-28-05 JF-mc

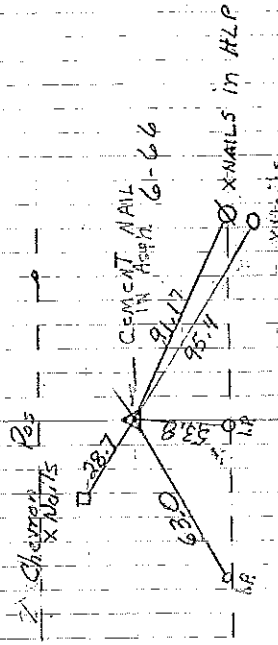

P.C. STA 7+43.9

6-13-66  
6-88 JFM  
Set PK 6-28-85 J Foster

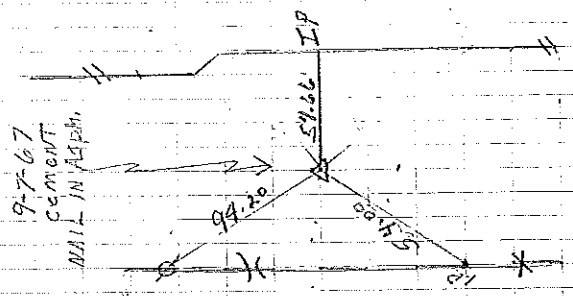

P.C. STA 17+36.12

Tied 6-13-66  
6-88

Set PK 4-88 R Anderson  
Set PK 7-28-05 J Foster

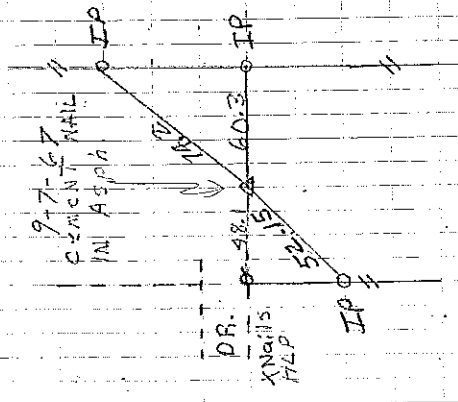

P.C. STA 21+28.7

Tied 6-14-66  
6-88

Set PK 4-88 R Anderson