

Sec 6-95-14

COR A PLUG

COR. B. STONE  
Iron Pin 1924 FAP 160  
Found  $\frac{5}{8}$  IP 9-19-03 File 2003-2979

COR. C  
1/2" ON PIN 1730 Drove IP  
Found IP point on set in on it 4-18-54  
Consultant found IP 2-22-05 File 2005-0317

577+35 P.I. FAP 160 P.I.

Cor G Found Stone Set # 5 Rebar 0.15' North  
of High point Stone is Cor. 6-81 Consulting Eng.

Cor. F K. Stark found pipe 11-5-04; File 2004-2556

Cor H Set nail in mat 6-24-08. File 2008-

STONE  
BRICK

17.64 ca Stone 17.64  
D

18.07 18.07

G 26.10 0 STONE C IP STONE

H 35.17 A 10.41 P STONE  
5/8" IP  
STONE

10x13x23 GRANITE  
COR. Pas + 13.5

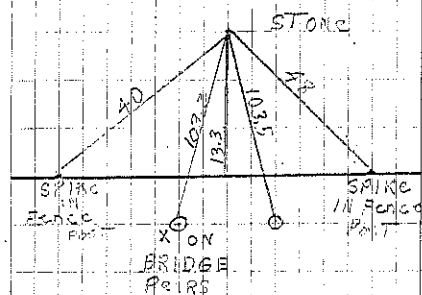

COR. A

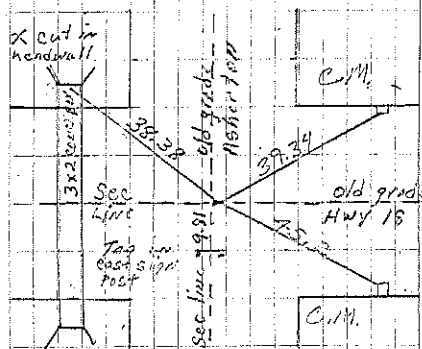

COR. B

P. Herald Retired 9-19-03

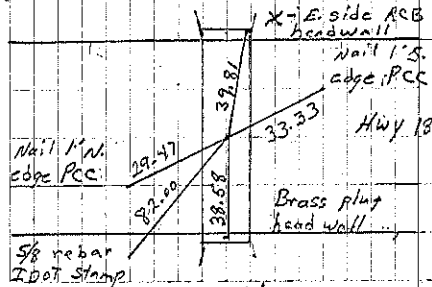

Cor. H

S. Steinfadt Retired 6-24-09

Chick K... W

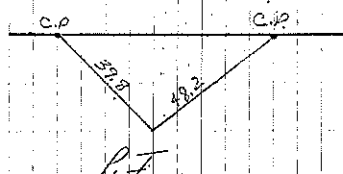

STA. 577+35

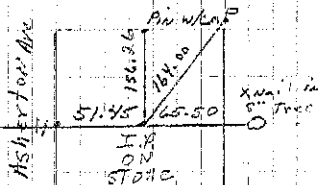

COR. C 4-18-57

K. Stark retired 02-22-05

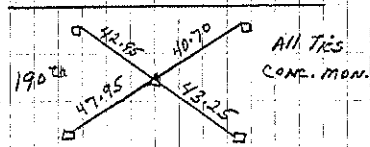

Cor. F

K. Stark retired 11-5-04

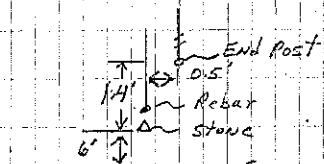

Cor. G