

COC. 1-95-13

COR. A I.S.H.C. 8-28-85 IDOT Alum Core  
Set Mag Nail w/washer 7-25-03 File 2003-2291

COR. B I.S.H.C. 8-28-85 IDOT Alum Core  
Find Mag nail w/washer 6-29-07. File 2007-1349

COR. C Found STONE DRIVE IRON PIN North side 8-31  
Find lead plug-cut x over 11-25-97. BK 166 pg 12

COR. H<sub>1</sub> File 2000-2267

COR. D 59.6 NE TAIL IN TRAC, 70° S. W. T. 2 I.P.  
59.6 NW NAIL IN H.L.B.  
55.0 E TO I.P.

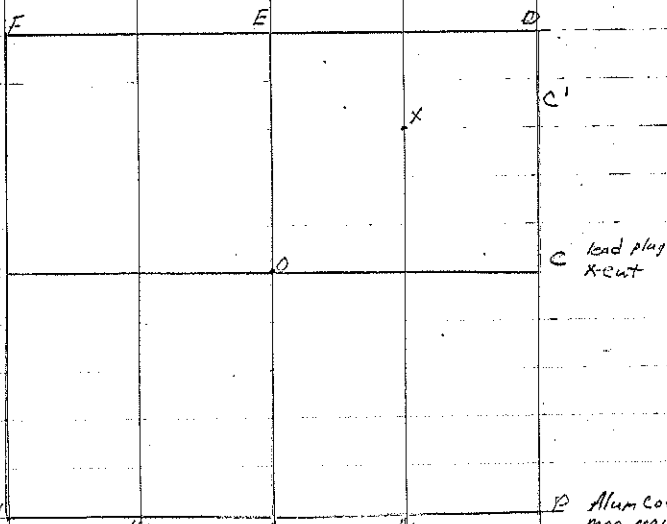

X See End of Book for C1-H/LX

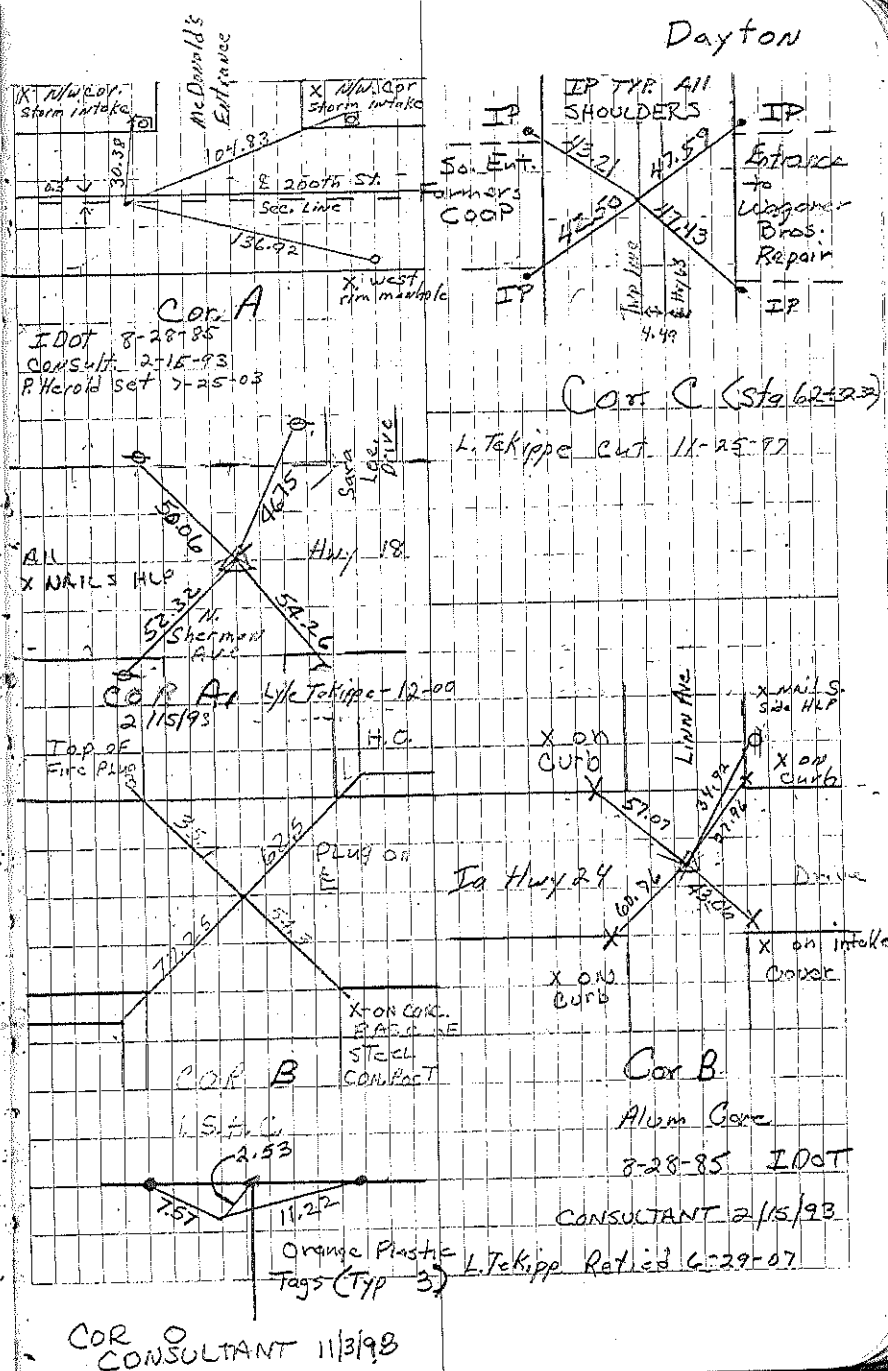

COR. D CONSULTANT 11/3/98

Sec. 1-95-13 Dayton  
 Cor. C' Tied by Kyle Tekippe - set 1/2" rebar  
 with 2" diam. cap LS 7060.  
 H' set X cut in PCC surface 7-25-03  
 File 2003-2390  
 X Set 1/2" rebar w/cap 12-5-03 File 2003-3662

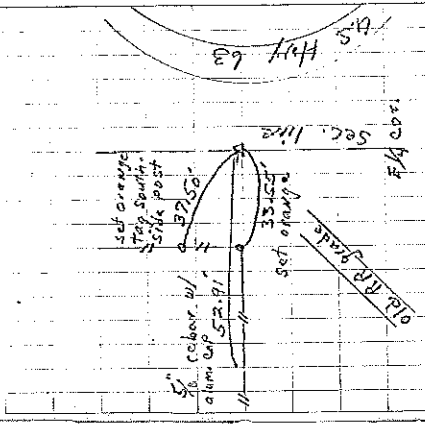

Cor C'  
 Tied by Kyle Tekippe - 12-01

Sec 2 95-13 Dayton  
 Cor. C' L. Endman set w/1 w/whisker 2-4-03  
 File 2003-0422. Set PK in new mat  
 10-27-04

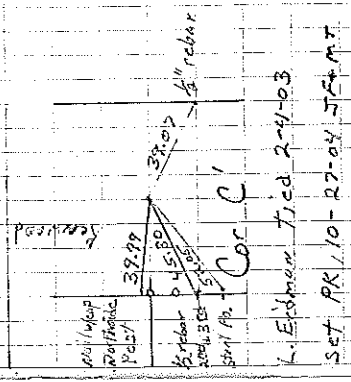

Cor C'  
 L. Endman Tied 2-4-03  
 SET PK 10-27-04 JET-MT