

Sec. 12-95-13

Cor A Consultant found IP 6/11/92 and tied in

COR. O Rod on Top Stone 33' from S. Post + a little west

Found iron Pin 10-30-47 & retied
Set mag nail w/washer 10-2-07. File 2007-1952

COR O1 Found PIN & Retied 6-22-60

Found PINE Retied 10-30-67

PANA

Cor B. Top of Manhole about 8-28-85 IDOT

Placed 2' off sets east & west 3-2-04 File 2004-0474

File No.

Cor C. Alum. Cor 8-28-85 IDOT. Set mag nail 3-2-04 2004-0473

Cor. A, Set 1/2" Rebar in Line With Monuments N + S

For ties to PC's + PT's See
Pages after Section 36 Dayton Twp

Cor x Consultant 2-17-91

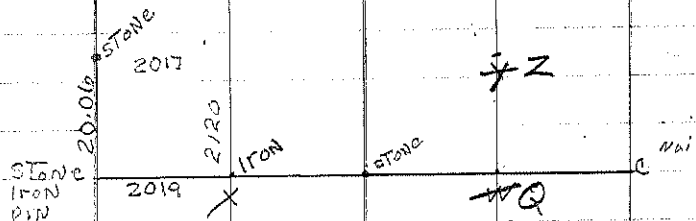

SEE AFTER Section 36 For Additional

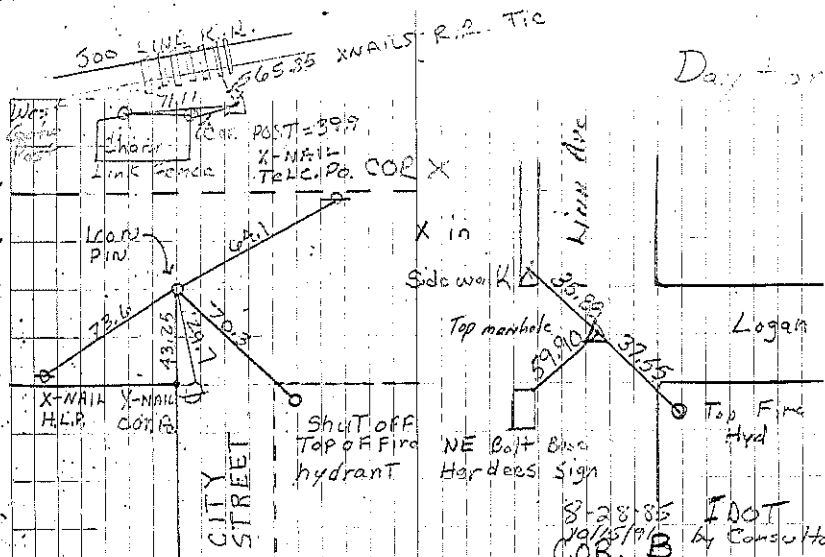

COR. O1 132.0' EAST OF COR O

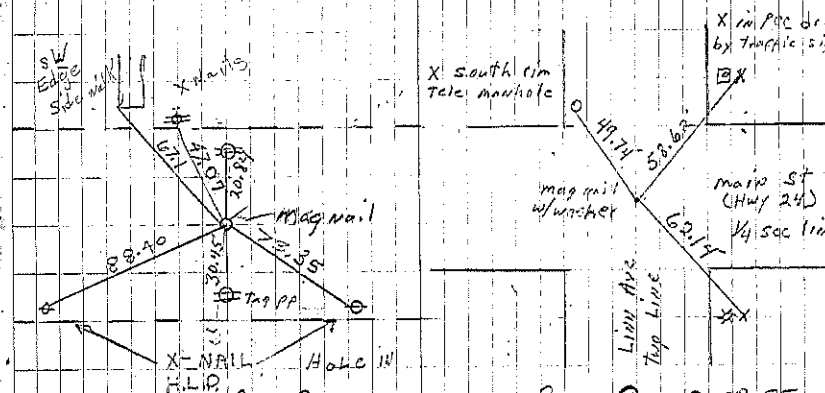

Cor. C 8-28-85

Retied 10/15/91 by Const.
P. Herald Retied 3-2-04

Retied Damage 10-31-67
Retied Consultant 2-15-93
P. Herald Set 10-2-07

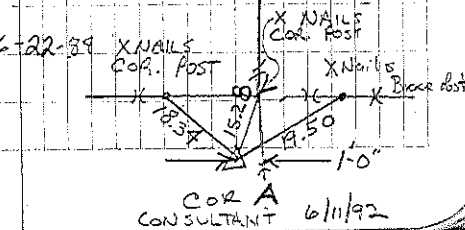
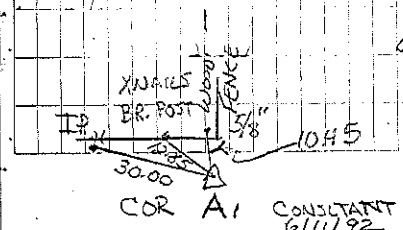

Dayton

Section 12-95-13 Dayton

PT STA 561+84.6 Good reading with Metal locator and tied in 6-21-88
Also Found Two old Ties

PC STA 563+74.3 Good reading with Metal locator and tied in 6-21-88

PT Sta 579+54.3 Retied 6-22-88

Cor-Z J NW Corner SW/4 SE/4 Section 12-95-13 set 1/2" rebar with cap 7060 by intersecting the south line of west view addition with the north - south quarter section line. 7/23/97

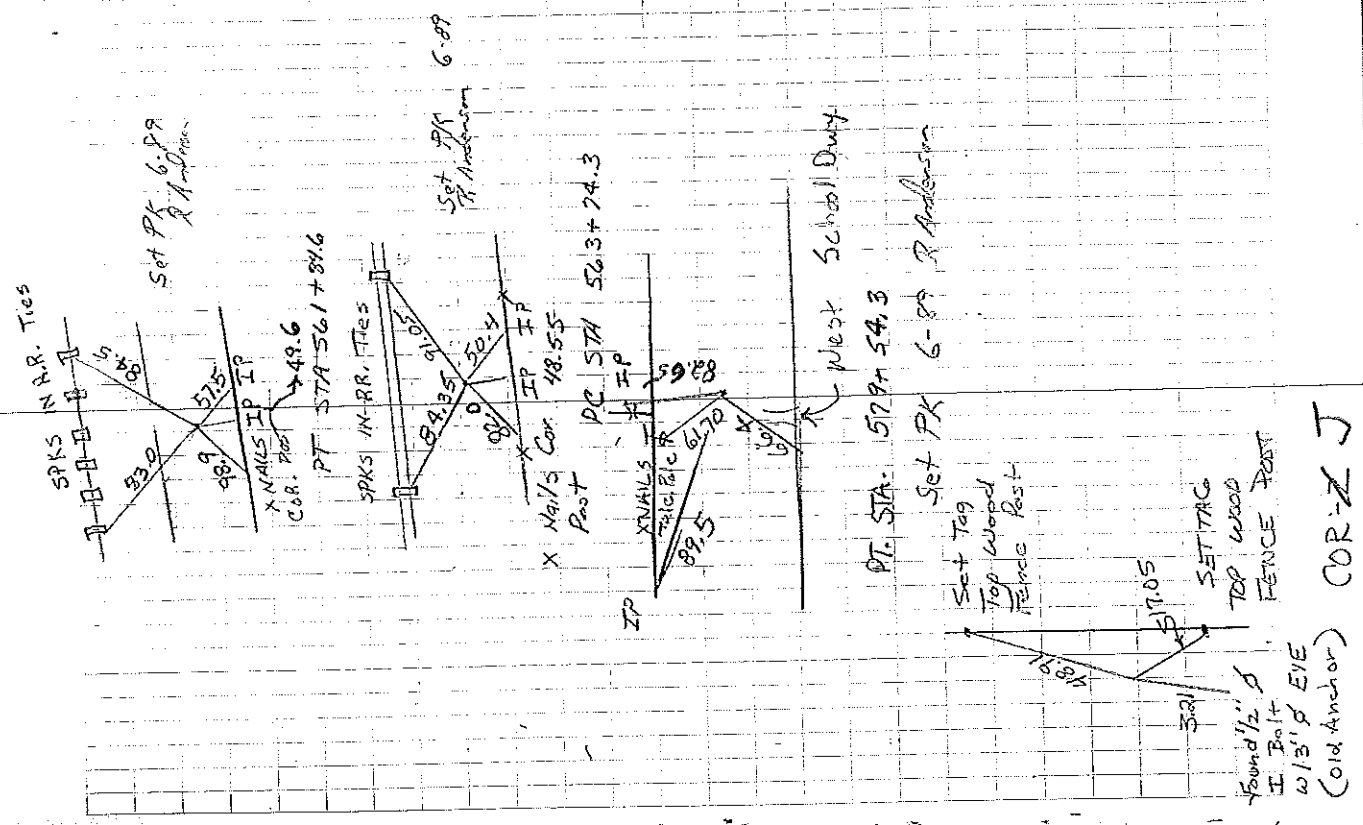

Section 12-75-13
 Cor XZ Dayton
 Set 1/2" rebar w/cap 7060 pt
 the intersection of the Quarter-
 Quarter Section lines. Fnd. 1/8" rebar

6-29-07, file 2007-1349
 Cor XQ Cut X in P.C.C. Street by extending
 the line from the old corner NE 1/4-NE 1/4
 south through the E of north sernan
 Ae, & position established from survey
 monuments of record, and intersecting
 the line with the quarter section line
 between the center and the east
 1/4 corner.

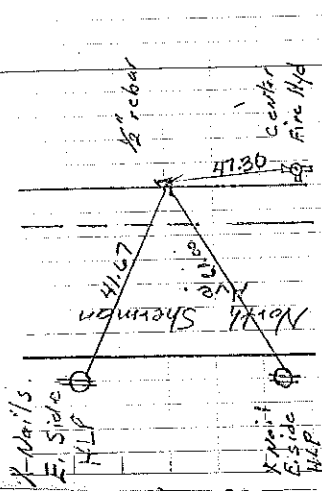

Cor. XZ

Consult 11-13-97

L. Tekippe Retired 6-29-07

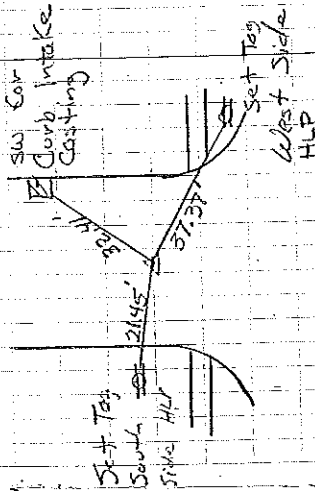

Cor XQ

Consult 11/13/97