

Sec. 19-95-13

COR A Stone
I.P. 6-6-52 Retired
Consultant 7/01/91

COR B Iron Pin 6-52 Retired. Find iron pin 11-2-64.
Find 1/2" twisted bar 11-2-07. File 2007-2150

| | | | | |
|---------------|---------|---------------|---------|--------------------|
| Stone I.P. | 17.15ch | 80.34ch | 21.22 | Stone |
| Stone | 2008ch | 2018ch | 2018ch | |
| Stone I.P. | 37.76ch | Iron 1382' | 41.90ch | |
| | 40.77ch | 79.42ch | | |
| Lime Stone | | A I.P. | 41.60ch | B Lime Stone |

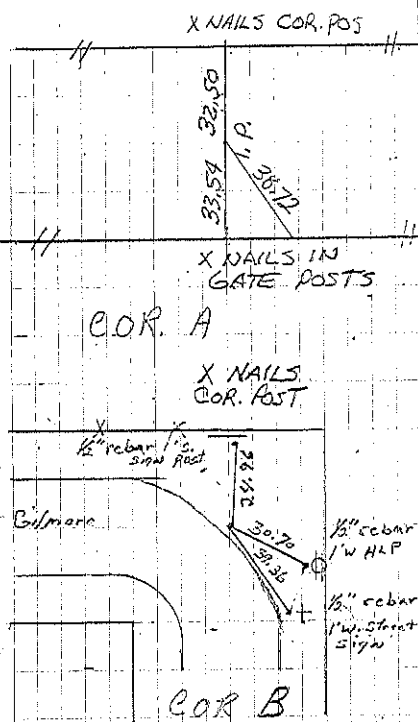

Consult: 7/91
P. Herold retired 11-2-07

Dayton