

Sec. 34-95-13

COR E. 7-24-53 FOUND OAK STAKE SET I.P.

COR A SET FOR CORNER ONLY  
L. T. Kippie retied 1-19-99 File 170-211

COR O Set 1/2" rebar with 2" aluminum cap L.S. 7060 1/19/99

Cor B L. T. Kippie retied 1-19-99 File 170-212

For corner not in this book see file of Land Corner Certificate AKA Survey and Section Ties File

2660.53

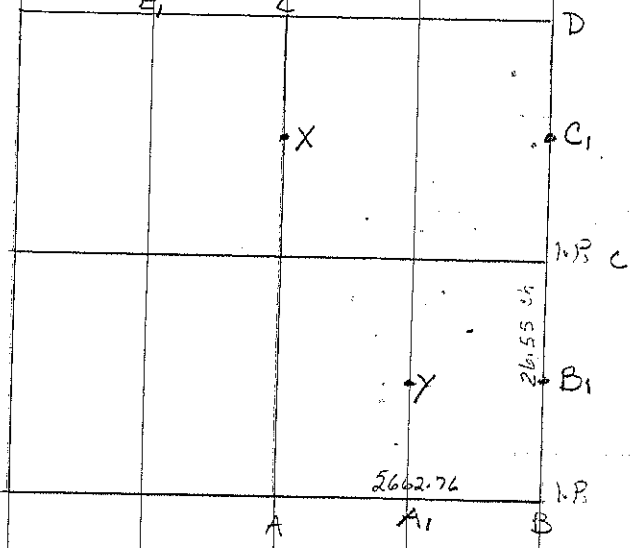

Dayton

