

Sec 7-95-13

COR B

Found Hub with Iron PIPE below 5 FT PIN
IN CENTER OF PIPE TO RAISE
5-3-50 DANA
Kruger, Cleveland

COR B

STONE I.P. 1929 From E. COR. PAST 9-2-25
I.P. Driven WITH STONE 33'

COR C

STONE I.P. (I.P. Driven WITH STONE 5-3-66
DANA, Kruger, Cleveland

Cor A

Set $\frac{1}{2}$ " rebar w/ aluminum cap 11-5-01
BK 2001 - pg 2441

Cor A'

See BK 2001 - pg 2441

36.97

STONE
 $\frac{1}{2}$ " Twisted bar

$\frac{1}{2}$ " IP
B

STONE

A Stone
 $\frac{1}{2}$ " rebar

A'

Dayton

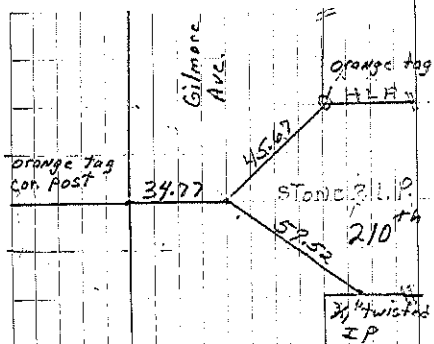

Cor. B
Paul Herold Retired 10-01

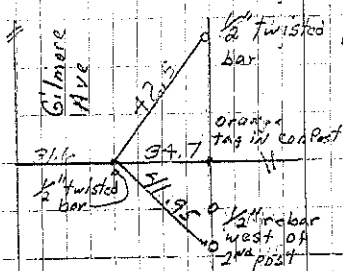

Cor. C

Paul Herold Retired 10-01

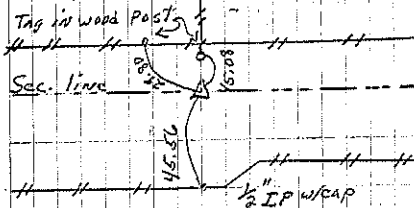

Cor. A
Paul Herold set 11-01