

DEERFIELD SOUTH

Sec. 19

B Found Stone & old wood, SET  
IP 33' From South Fence

A Found large limestone 33"  
From south post. (IRON POST IN CEMENT)  
Found large limestone 33' from  
South Post, SET I.P. ON stone Retied  
9-14-57 O'NEILL.

A<sub>1</sub> Consultant found IP and retied 4/23/94  
Fnd bent 1/2" rebar 3' deep. Placed 1/2" rebar with  
chickasaw county cap along side & bent so cap  
is directly over original straight rebar. Retied  
7-19-07

Stone in line with  
Fence from S.P. 33'  
From Fence Post

limestone

1/2" rebar

A<sub>1</sub>

I.P.

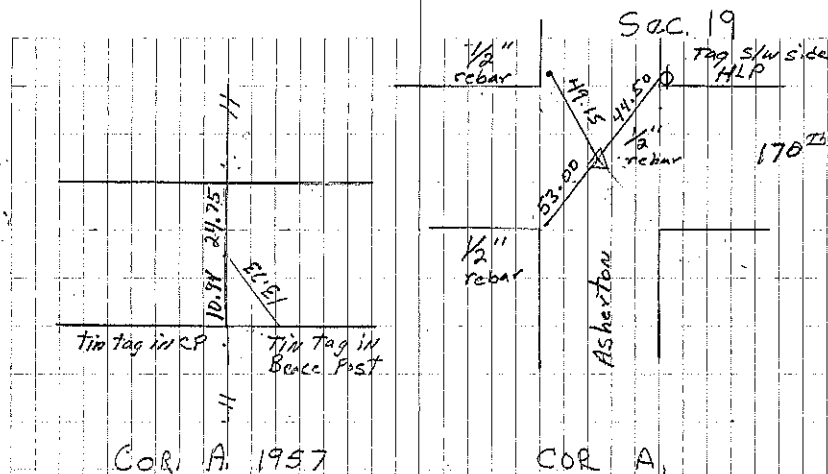

COR A, 1957

COR A,  
By Consultant 4/23/94  
Revised & retied 7-19-07 JF