

B Found Stone 33' from N. Post
Drove Angle Iron over Stone 5-10-37

A Set iron rod midway between
fences 28.5 from either iron post
set 1/2" rebar w/cap 6-7-99. File BK172 pg 50

B Found angle iron 20" deep. Set iron pin over.
8/79

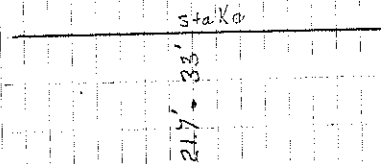
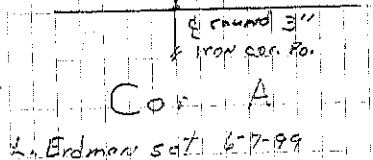
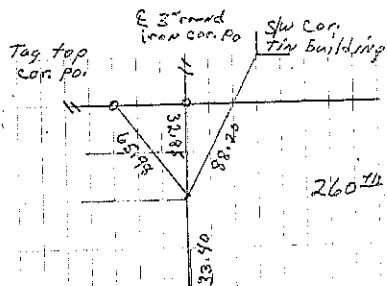
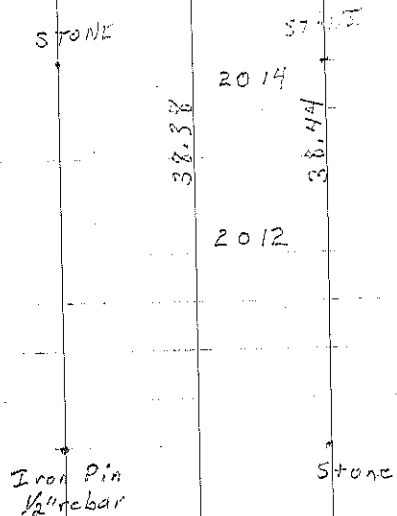

Cor B

Fredericksburg Township
Sec. 5

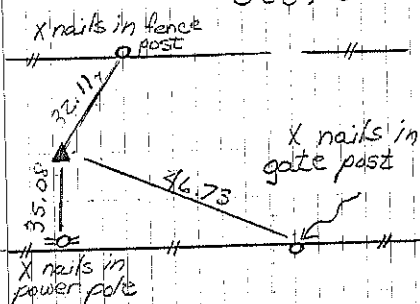

Found angle iron 20" deep
Set iron pin over
Cor B 2/79
Consultant 8/22/95

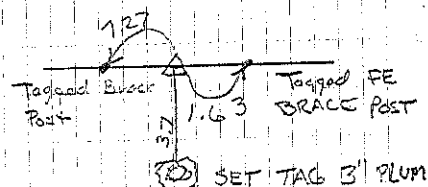

Cor C
Consultant set IP
.2' South of Granite
Stake Found 8/22/95