

O Center Sec Old Shaft with
 center Pin in End in line with
 fence west. Set Nail in Asph 8-17-71

A S 1/4 Cor Gas Pipe
 Set Nail in Asph 8-17-71

B Set 1/2" rebar w/cap 6-7-99. File BK172 pg 51

Angle Iron

Old shaft

PK

2667.88

Gas pipe
 PK

1/2" rebar

Sec. 6

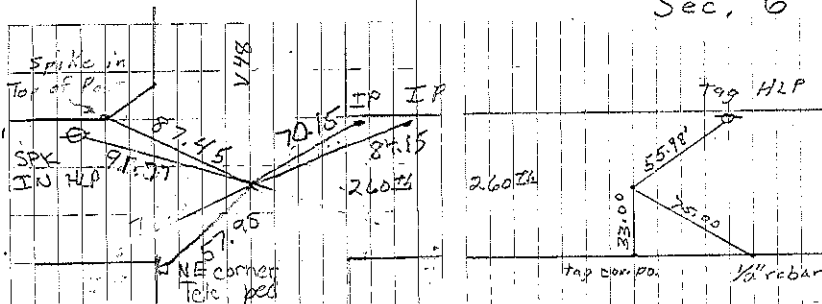

Cor. B

L. Erdman Set 6-7-99

Cor. A

set nail in Asph 8-17-71

set nail in Asph 7-29-83

CONSULTANT 6-15-92

Retired 5-21-90 JF-SH 4-97 JF-JD

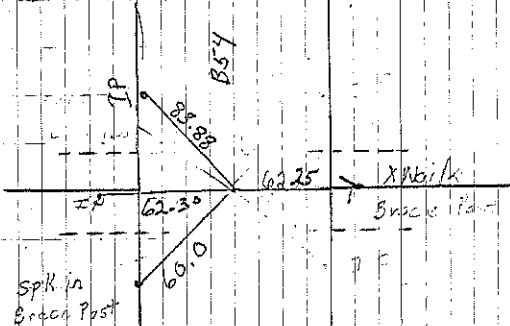

Cor. O

set Nail in Asph 8-17-71

set Nail 7/16/92

set PK 4-99 JF-JD