

A 7-9-85 IDOT Alum Car.
File 149-463
stone with Iron Pin

B 7-9-85 IDOT Alum Car. P. Herold set 1/2 rebar 1-02

Cor O Set Iron Pin between fences for P.I. & tied 6-13-69

Cor O Found nail in asphalt. 2/79

Cor A Found nail in asphalt. 2/79

Cor B Found lead plug. 2/79

Cor C Set steel fence post 6" exposed. 2/79

Cor X I Set IP from old Records (Consultant)

This is not a land corner one affidavit dated 6-30-95 by

Lyle G. TeKippe

Cor Z 3/4" IP Retied by Consultant 1/5/96

Iron Pin

Iron Pin IP
X-I

N89°16'56"E
2316.60

N89°43'03"E
2643.98

FOR ADDITIONAL TIES SEE AFTER SEC 36

Fredericksburg Township
Sec. 7

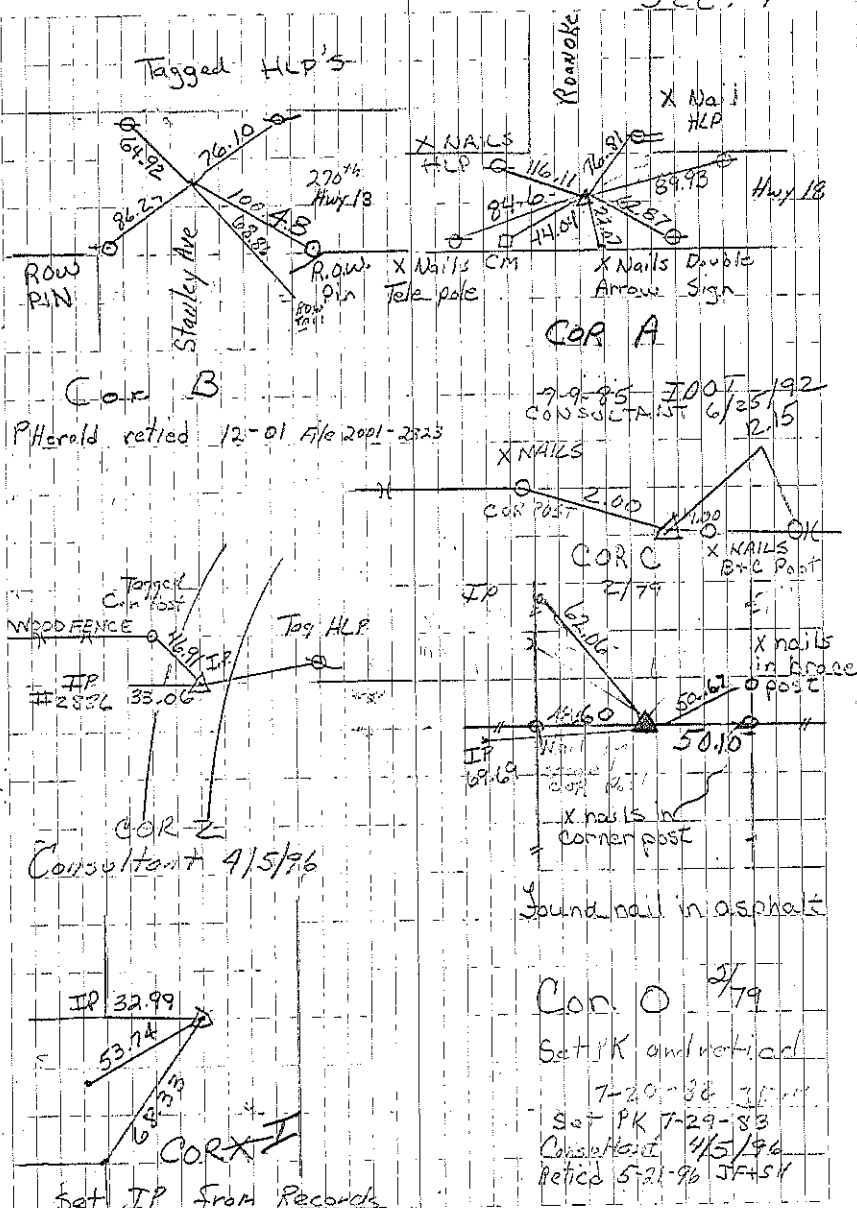

Set IP from Records

Tied in 1/6/93
by Consultant
This is not a land corner

Section 7-94-11

STA EQUATION 39+07.3 BACK = STA

43+56.3 AHEAD From County

Grading Plan 68 Project No

S-2284 (3) 1958 County Set

this Point and used for staking

R.O.W. for road to the SW

Stofus property

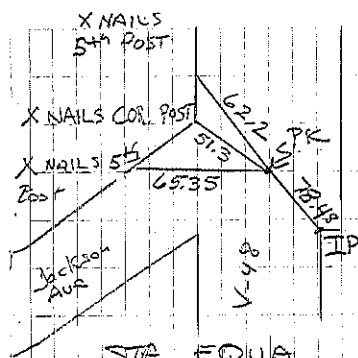

STA EQUA

STA 39+07.3 BACK

STA 43+56.3 AHEAD

Set P.K. Tied in 5/21/96 JF
4-99 JF