

- Richland
- A Iron Pin Ref'd 1950. Set nail in AC 9-17-87.
Fnd. $\frac{1}{2}$ " rebar w/alum cap 5-12-07. File 2007-0971
Fnd $\frac{1}{2}$ " rebar (cap missing) 10-23-07 File 2007-2074
- B Iron Pin Ref'd 1950. Set nail in AC 9-12-87
- C Iron Pin 3-12-80 smt IP in line with East fence
- O Fnd. $\frac{1}{2}$ " rebar w/alum cap 5-12-07. File 2007-0972
- Q Set $\frac{1}{2}$ " rebar w/alum cap 5-12-07. File 2007-0972

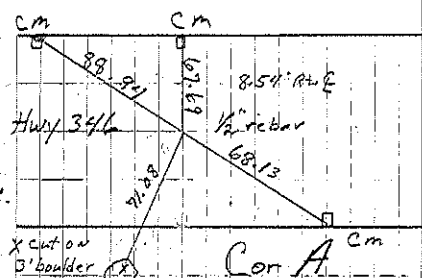

Set Nail in AC 10-11-60
8-1-85 IDOT
Set 9-17-87 IDOT
P. Herold retied 5-12-07
G. Casady retied 10-23-07

33' Cor. Pol.

Cor. C

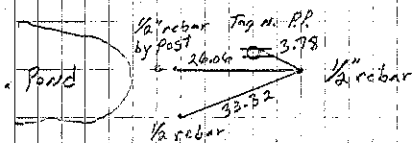

Cor. O
P. Herold retied 5-12-07

Sec 11

