

A Richland Iron Pin 11-14-20 Set Iron Pin  
 B Stone 1-1-20  
 C Iron Pin 1920 Consultant 2-1-95  
 C<sub>1</sub> Consultant Set 1/2" bar with cap 2-1-95

Stone 1318<sup>s</sup> Iron Pin  
 40.28 H<sub>1</sub> Stone

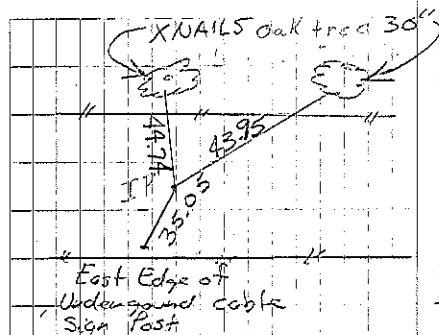

Cor A  
 by Consultant  
 4/10/92

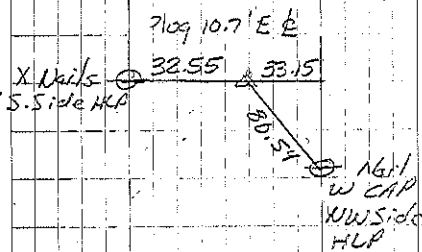

Cor C  
 CONSULTANT  
 2-1-95  
 X NAILS  
 IN POST

Cor H<sub>1</sub>  
 X NAILS  
 in wood  
 POST  
 by Consultant 4/10/92

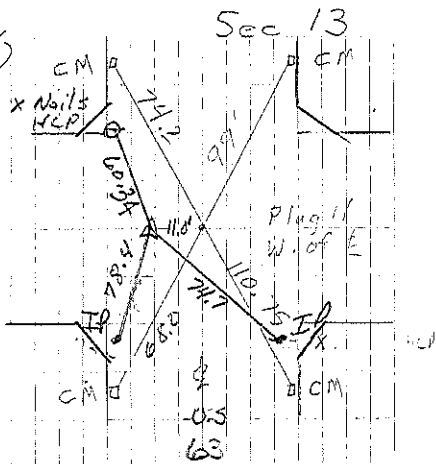

Cor B  
 Alum Cap  
 by Consulting Eng 4/10/92

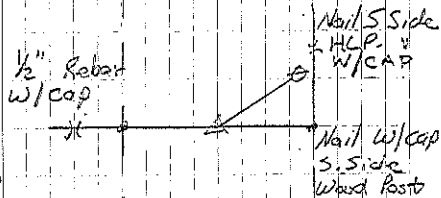

Cor C<sub>1</sub>  
 Consultant 2-1-95