

Stapleton

B Stone IP 1928 Found Pin 4-8-68

Fwd & raised with 1/2" rebar 4-16-97, File 2007-0734

C Reset 1949 Iron Pin.

Found 7-10-69 Road West

40' south 26' North.

Found 1" twisted rebar 11-9-98. BK 169 pp 349

Limestone F Tile

Whistle Post N 83.7
Tale. Pole SW 59.2
Cor Po S 46.0
Cor Po N 67.0
RR & E W 18.7

Granite
Iron Pin

2653

2671.2

Sec
Sect

CM ST. P. P. R.

1837

Limestone
3432 Form
& 1/4 Cor.
to Milw.

2642.5

Limestone

Granite

2671.2

Stone
4 x 10 x 15
26.7 Cor B SW
35.1 Tale. P. NW
32.3 Post N
32.9 IP SE

40.24 ch

2655.6

6 x 10 x 14 Limestone
NE-35
N 23.6

Sec
Sect

40.12 ch.

SE 37.9

5 x 18 x 18

Stone

E 23.5

W 23.5

40.00 ch

Sec
Sect

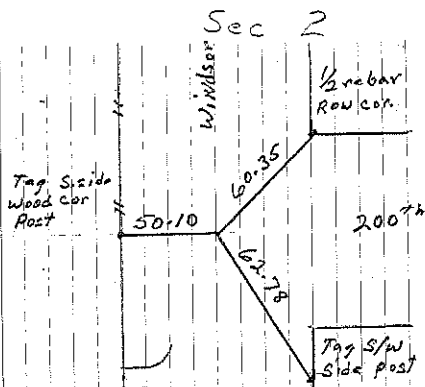

Cor B

7-10-69
P. Herold retied 4-16-07

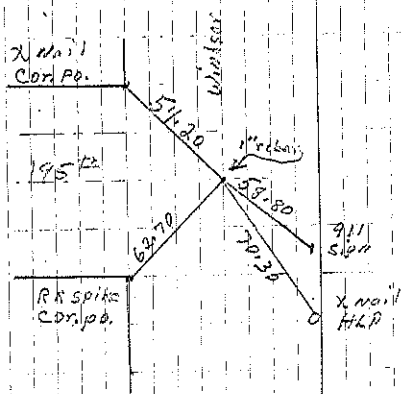

Cor C

7-10-69

S. Busse Retied 11-9-98