

Station

A

Angle Iron 10-14-49 Found 6-12-69

Set PK in mat 4-99

B

Found Stone 33' from Stake to S.

Found PK nail 6-25-98. BK 168 pg 83

O

Set I.P. between fences and made straight line for this mile P.O.T.

6-13-69

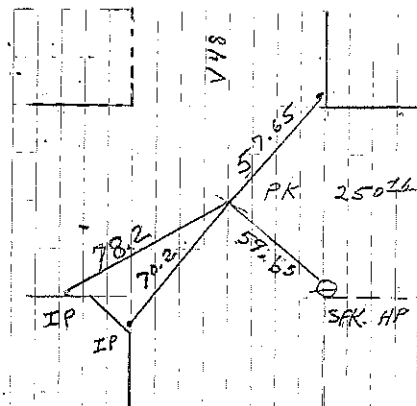

Cor. A

Set Nail in Asp 8-17-71

Set PK 7-29-83

Retied 5-22-96 JF+SH

Set PK 4-99 JF+ID

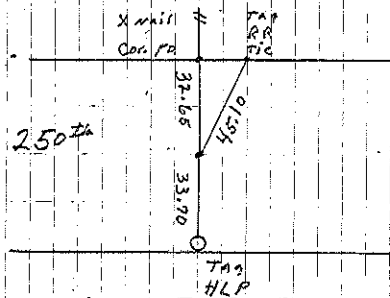

Cor. B

S. Busse retied 6-25-98

Sec 31

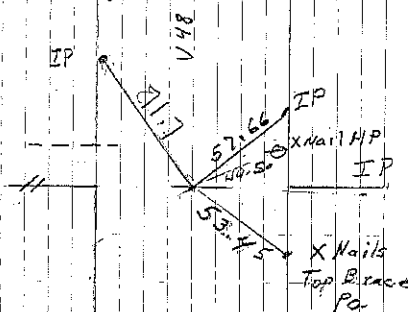

Cor. D

Set Nail in Asp 8-17-71

Set PK 7-29-83

Retied 5-22-96 JF+SH