

UTICA S

Sec. 24

COR. C Stone (Found) 42.0' From spike
IN OAK TO EAST + 39.8 FROM N.W.
COR. Post Consultant Found I.P. and
retied 12/27/95

COR. A Set IP 8-1-55

Cor. O Found old IP and tied in
4/22/96

E. Side Section of RAILLINE

3 CONCRETE BROWN GRANITE
18x18x6 W/BI. FENCE 10.6 FR
RD. FENCE 33.7 FR

2012

Stone

2012

Stone

4024

BROWN
GRANITE
STONE
18x10x6

IRON
PIN

I.P.

Sec. 24

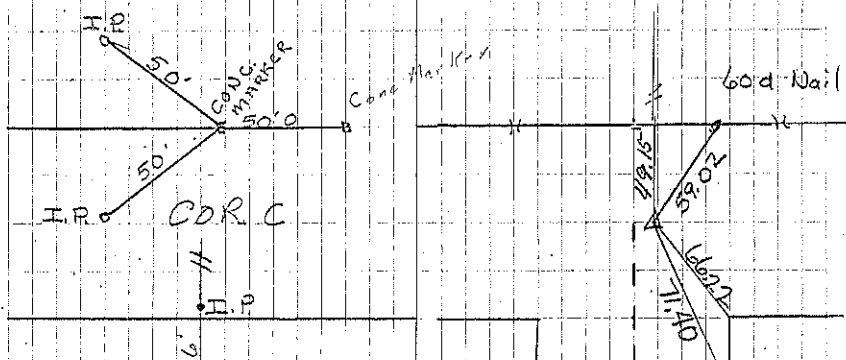

Cor. C?
Consultant 12/27/95

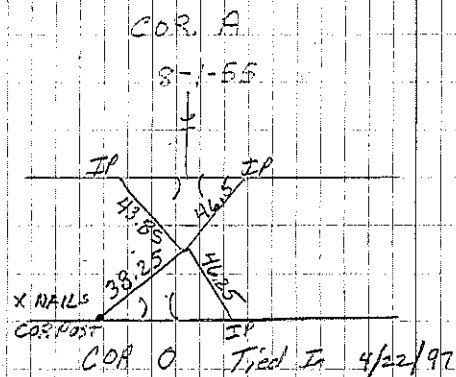

WHITE GRANITE STONE
18x18x8
Fence EAST 30.7 FR

FENCE
EAST 24.4 FR
WEST 22.5 FR