

UTICA S

SAC. 26

COR. C SPIKE 1927

Hub #
COR. E IRON PIN 1927

B SET IRON PIN 8-5-31
Found Pin, Raised & Retied 4-16-56

COR. C SET IRON PIN 5-10-56 FOR
CONSTRUCTION ONLY, SOUTH

COR. D FOUND IRON PIN WITH EXE HUB ALONG
SIDE, RAISED & TIED 11-3-67
Found 1" gas pipe 11-28-06, File 2006-2430

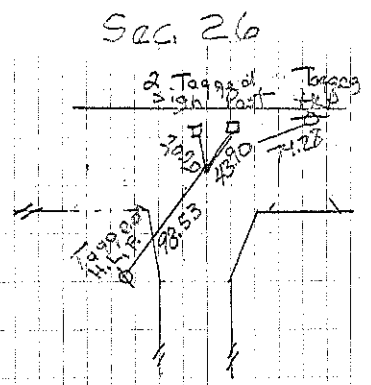
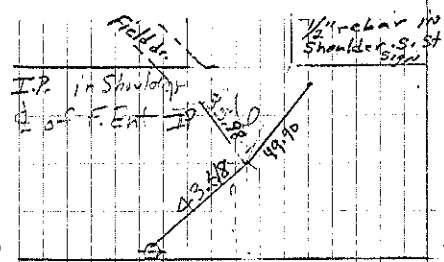

COR. O Center
Consultant 7-5-95
P. Heineold Found 11-28-06
School YARD SECTION

COR. C 5-10-56
CONST. ONLY
Retied - 6-3-59

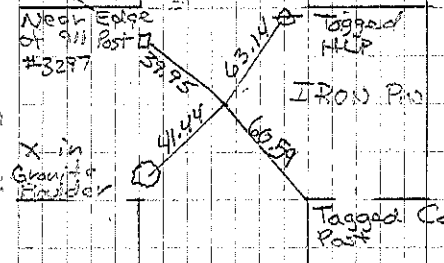

COR. B
Retied 4-16-56
DATA

