

UTICA S

Sec. 29

2005  
H.M.C. Tower

Sec. 28

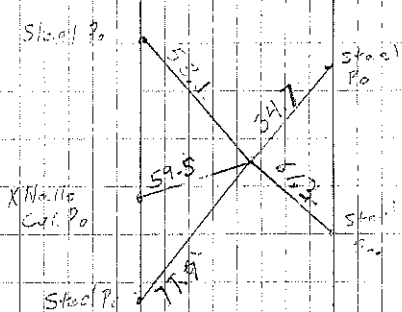

Ret. for N. W. P.I.  
 STA. 497+92.2  
 $\Delta = 9^{\circ} 34' 30''$  L+  
 Set Nail in Mat  
 8-30-67  
 OK 4-19-72 E.D. Ret'd 5-23-76  
 6-19-78  
 Set PK 10-24-94 M.F. SF

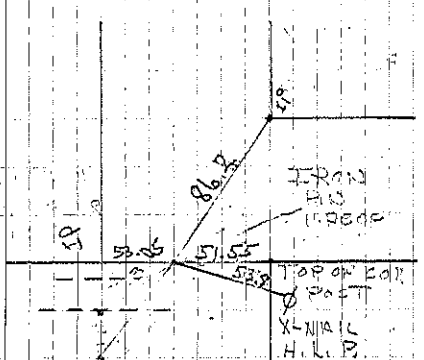

COR. C STA=515+31  
 Ret'd 7-13-59  
 Ret'd 5-23-62 D.M.A.  
 Set cement nail in  
 MAT 8-30-67 OK 4-5-72  
 Ret'd 10-1-76 Ret'd 5-23-96 SF+SH  
 Set PK 10-24-94 M.F. SF  
 Ret. for N. W. P.I. STA  
 507+00  
 $\Delta = 9^{\circ} 14'$  R+  
 Set Nail in Mat  
 at N. W. P.I. STA 511+00  
 OK 4-19-72 E.D.  
 6-19-78  
 Set PK 10-24-94 M.F. SF