

B Iron Pin Stone 5-28-54, Found sp. pin 11-28-70.
Bk. 146 pg 112

C Iron Pin 4-30-79
Measured 40.25 ch from Cor B
split fences, found Cor. Stone
with 1/2" above + post along
side 8-11-79

G1 Tied in by HRG 11/28/90
Not sure where this J.P. came
From G1 Entered in this book 1/7/91
off of information given by Howard
R. Green Co. JFM

20.125 20.12 40.25

G1

Sec 33

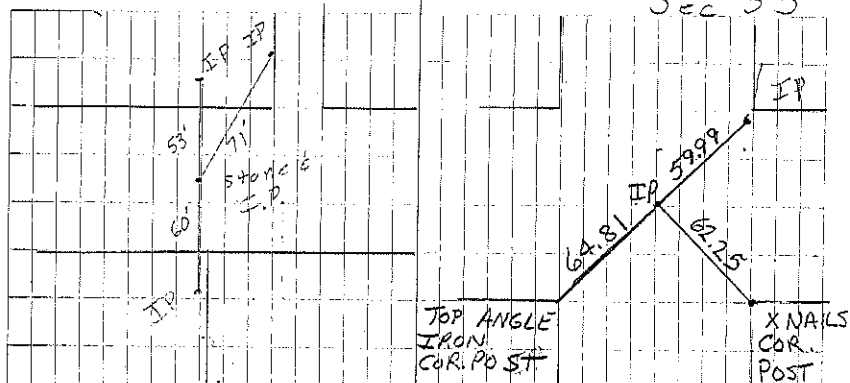

Cor A

Cor. B

Tied in by HRG 11/28/90

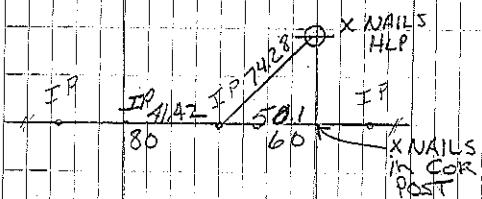

Cor C

Tied in by HRG 11/28/90

