

Washington N Sec. 19

A<sup>2</sup> IRON PINS 1924 Bassett ALTA VISTA  
(Co. Road Tracing) THIS IS

NOT a LAND MARK.

Found IRON PIN

B Stone 11-22-21 Book 26 Pg. 70.

Large boulder with brick & GRIP

on North side of 60 perry SPK W

CENTER of 600 pipe

C IRON PIN 40' From I.P. EAST. 50'

From I.P. So. EAST 5-22-51.

A' Found I.P. Recessed Ties OK 6-27-55

E? See Back of Section 36 (WASH SOUTH)  
SPK IN check Top J.H.C. plans  
next page in this book

H Found I.P. Set Ties with TRANSIT 10-21-51  
Retied 5-1-61. Fud. X in conc. 10-19-07. File 2007-2120

F STONE 314 From N. Post  
D STAKE WITH STONE around COR. D.

50' NW I.P.

50' NW "

50' SW "

50' SE "

5-28-54

H Stone

A<sup>2</sup> Stone X in conc.

A'

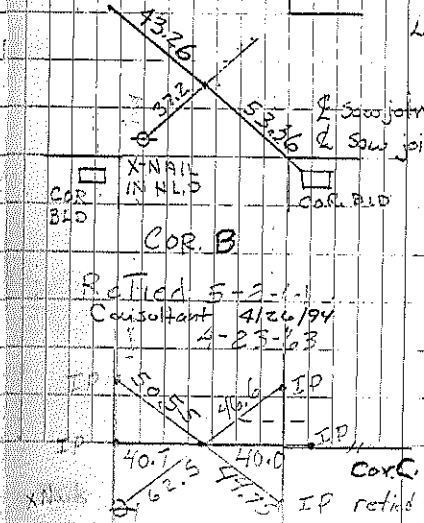
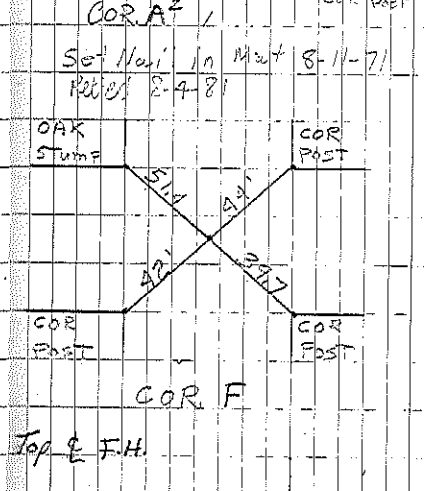
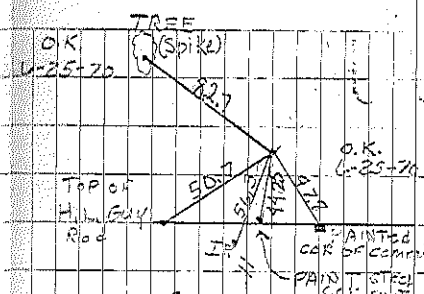

Sec. 19

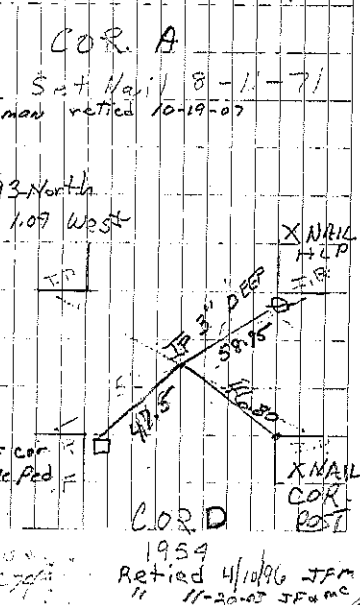
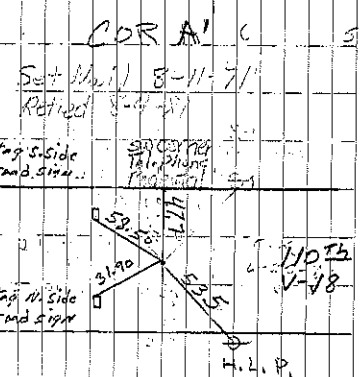
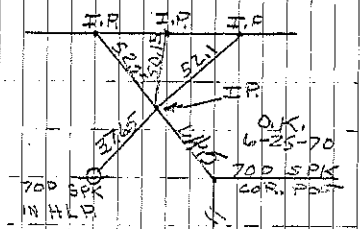

1954 Retied 4/10/96 JFM  
" 11-20-03 JFM mc

Washington N

COR E Dug hole and found stone  
19-97-13 3" below surface which was  
33' North of old Corner post  
to the south Set IP.

Cor B Sec 30-96-13  
Found "X" cut in PCC 9-21-07 File  
2007-1910

N- Sec 19  
7

