

Filed 2005-0038
2005 Jan 7 8:57 AM

Lee O. Gallentine LS, Ryken Engineering, 711 Park Avenue, Ackley, IA. 50601 - Ph. 641-847-3273 - Fax 641-847-2303

UNITED STATES PUBLIC LAND SURVEY CORNER CERTIFICATE

OF

Land Survey Monuments situated in Section 31, Township 94 North, Range 14 West, of the Fifth Principal Meridian, Chickasaw County, Iowa,
Previously recorded in Not Applicable in County Recorder's Office

(Show reason for preparing this certificate, the evidence and detailed procedures used in establishing the corner positions and monumentation found or set.)

Monument Description and Remarks:

NW Cor - Floyd Co Rec's Inst #1997-1663 indicates that corner is monumented with '1" pipe'. Floyd Co Engr's records indicate that corner is monumented with 'Gas Pipe over Hardhead'. Chickasaw Co Engr's records indicate that corner is monumented with 'Pin over Rock' with ties as shown below.

Searched area with metal detector and found 1" iron pipe 0.3' deep in centerline of gravel roads N-S and E-W. Monument found matches that of record and record ties are within reason. Therefore, used pipe as the correct corner. All ties are plumb distance unless indicated otherwise.

This certificate is being prepared because there are no certificates on file for this corner and this corner was used for a survey in this section for Wendell E and Lillian D Lampson.

Plan View

(Show a minimum of three reference ties to durable physical objects, relevant monuments, and physical conditions that will enable recovery of the corner.)

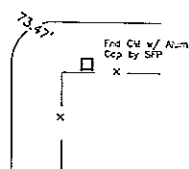
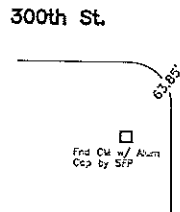
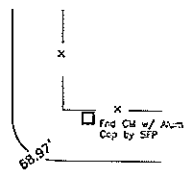
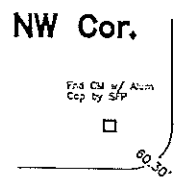

Legend

- BC = Nail w/ Bottle Cop
- BP = Brace Post
- CP = Corner Post
- CM = 4" Sq Concrete Monument w/ 1/2" iron rod in center (tie to rod)
- CX = Cut 'X'
- GP = Gate Post
- GPW = Nail w/ Green Plastic Washer
- PP = Power Pole
- RH = Red Head (Nail in wire)
- SFP = Steel Fence Post
- RW = Nail w/ Reflective Round Washer
- R/W = Iron ROW Nail
- SM = Yellow Plastic Survey Marker
- SW = Nail w/ Square Metal Washer
- TP = Telephone Pedestal
- TW = Nail w/ Round Metal Washer
- WFP = Wood Fence Post
- X = X Nails

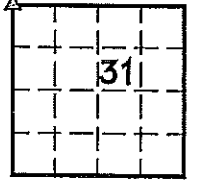

CO ENGR'S RECORD TIES

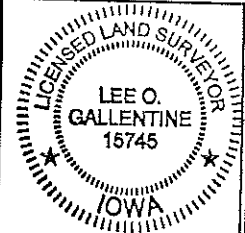
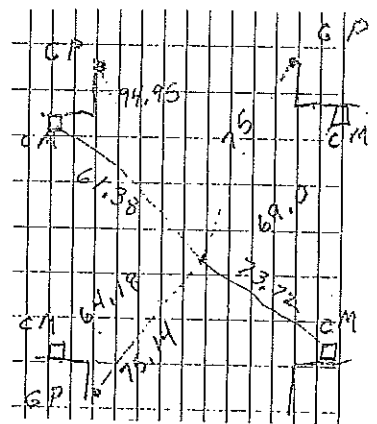

I hereby certify that this land surveying document was prepared and the related survey work was performed by me or under my direct personal supervision and that I am a duly licensed Land Surveyor under the laws of the State of Iowa.

Lee O. Gallentine
LEE O. GALLENTINE, LS
Date: Nov 4, 2004 License number: 15745
My license renewal date is December 31, 2004

List Corners to be Indexed

Corners	Section	Twp	Range
NW Cor	31	T94N	R14W