

Filed 2005-0041  
2005 Jan 7 9:00 AM

Lee O. Gallentine LS, Ryken Engineering, 711 Park Avenue, Ackley, IA 50601 - Ph. 641-847-3273 - Fax 641-847-2303

## UNITED STATES PUBLIC LAND SURVEY CORNER CERTIFICATE

OF

Land Survey Monuments situated in Section 31 Township 94 North, Range 14 West, of the Fifth Principal Meridian, Chickasaw County, Iowa,

Previously recorded in Not Applicable in County Recorder's Office

(Show reason for preparing this certificate, the evidence and detailed procedures used in establishing the corner positions and monumentation found or set.)

### Monument Description and Remarks:

NE Cor SE 1/4 Fr NW 1/4 - No available county records indicate that this corner was ever monumented.

Searched 10' area centered on point equidistance between N 1/4 Cor and Center with metal detector and found nothing. Since no monument can be located, set 'Survey Mark' nail equidistance between N 1/4 Cor and Center (see plat filed with this corner certificate for measurements) in accordance with accepted PLSS methods and used it as the correct corner. Nail is flush in centerline of southbound lane of ACC road N-S and in-line with fence line W. All ties are plumb distance unless indicated otherwise.

NW Cor SE 1/4 Fr NW 1/4 - No available county records indicate that this corner was ever monumented.

Attempted excavation around corner post and encountered dense tree roots 0.2' deep on all sides of corner post, making further excavation or probing impractical without removal of 5 split tree shown below. Since no monument can be located, set 3/8" x 1.0' orange capped iron spike (#15745) in tree root at the intersection of straight lines between opposite 1/4-1/4 corners (see plat filed with this corner certificate for measurements) in accordance with accepted PLSS methods and used it as the correct corner. Spike is 0.5' W of fence N-S and 2.5' S of fence E. All ties are slope distance unless indicated otherwise.

This certificate is being prepared because there are no certificates on file for these corners and these corners were used for a survey in this section for Wendell E and Lillian D Lampson.

### Plan View

(Show a minimum of three reference ties to durable physical objects, relevant monuments, and physical conditions that will enable recovery of the corner.)

NE Cor. SE 1/4 Fr NW 1/4

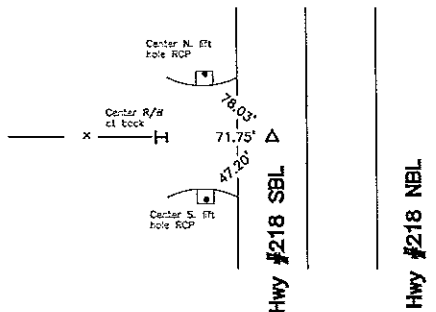

#### Legend

- BC = Nail w/ Bottle Cap
- BP = Brace Post
- CP = Corner Post
- CM = 4" Sq Concrete Monument w/ 1/2" Iron rebar in center (tie to rebar)
- CX = Cut X
- GP = Gate Post
- GPW = Nail w/ Green Plastic Washer
- PP = Power Pole
- RH = Red Head (Nail in wire)
- SFP = Steel Fence Post
- RW = Nail w/ Reflective Round Washer
- R/W = Iron ROW Nail
- SM = Yellow Plastic Survey Marker
- SW = Nail w/ Square Metal Washer
- TP = Telephone Pedestal
- TW = Nail w/ Round Metal Washer
- WFP = Wood Fence Post
- X = X Nails

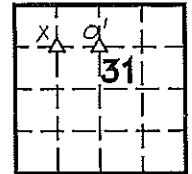

NW Cor. SE 1/4 Fr NW 1/4

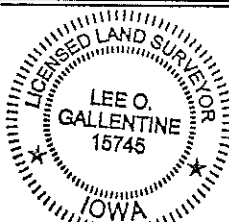
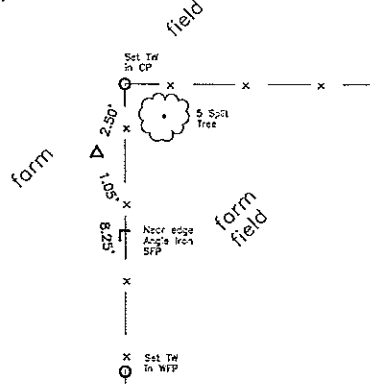

I hereby certify that this land surveying document was prepared and the related survey work was performed by me or under my direct personal supervision and that I am a duly licensed Land Surveyor under the laws of the State of Iowa.

*Lee O. Gallentine*  
LEE O. GALLENTINE, LS  
Date: Nov 4, 2004 license number: 15745  
My license renewal date is December 31, 2004

Pages or sheets covered by this seal: 1

### List Corners to be Indexed

Corners	Section	Twp	Range
NE Cor. SE 1/4 Fr NW 1/4	31	T94N	R14W
NW Cor. SE 1/4 Fr NW 1/4	31	T94N	R14W