



Prepared by: Erdman Engineering, P.C., 708 Commerce Drive, P.O. Box 246, Decorah, Iowa, (563)382-4194

UNITED STATES PUBLIC LAND SURVEY CORNER CERTIFICATE  
 OF

Land Survey Monuments situated in Section 12, Township 95 North, Range 14 West, of the Fifth Principal Meridian, Chickasaw County, Iowa, Previously recorded in does not apply in the County Recorder's Office.

Monument Description and Remarks:

This certificate is prepared in accordance with Section 355.11 of the Code of Iowa. No previous certificates have been filed for these corner locations.

WNW 1/8 Corner: We found no record of the WNW 1/8 Corner being set. We found no evidence of a monument in the field other than the county road and a fence line running east. We found the NW Corner and the W 1/4 Corner. We computed the location of the WNW 1/8 Corner on line and midway between the W 1/4 Corner and the NW Corner. This location was ±24' north of the fence line running east. We set a Mag-nail with 1 1/2" diameter stainless steel washer #11442 on line between the NW Corner and the W 1/4 Corner and in line with the fence line running east as the WNW 1/8 Corner of Section 12, Township 95 North, Range 14 West.

NW 1/16 Corner: We found no record of the NW 1/16 Corner being set. We found no evidence of a monument in the field other than an existing ±5' tall, 2" angle iron set in concrete being used as a fence corner with fence lines running west and south. We used the fence corner as the NW 1/16 Corner of Section 12, Township 95 North, Range 14 West after comparing the distances to adjacent corners in this Section. We set a 1/2" diameter steel bar with 1 1/2" aluminum cap #11442 on the northeast side of the post.

PLAN-VIEW  
 (NOT TO SCALE)

WNW 1/8 CORNER

Set Mag-nail with 1 1/2" diameter stainless steel washer #11442

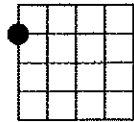

SECTION 12

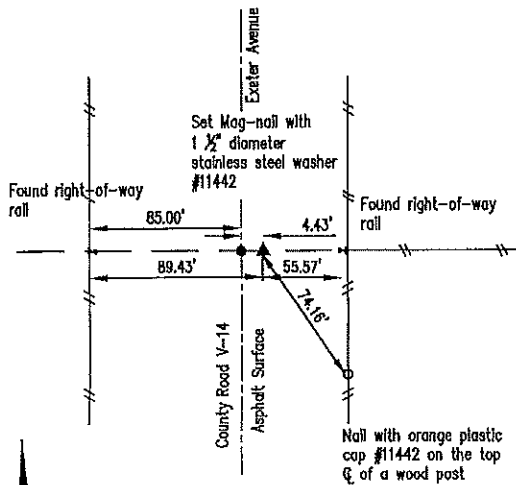

Cor. C1  
 Sec. 11-95-14

NW 1/16 CORNER

2" angle iron post in concrete used as existing fence corner

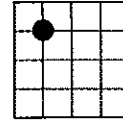

SECTION 12

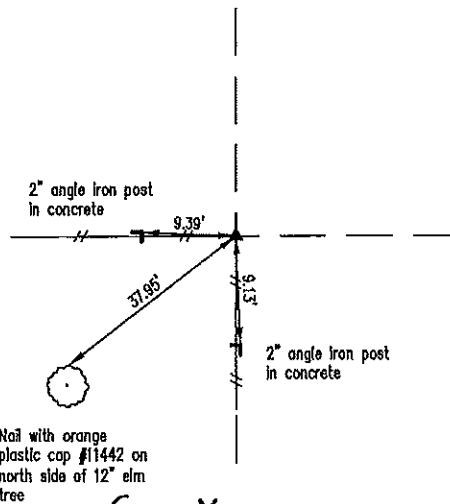

Cor. X  
 Sec. 12-95-14

I hereby certify that this land surveying document was prepared and the related survey work was performed by me or under my direct personal supervision and that I am a duly licensed Land Surveyor under the laws of the State of Iowa.

*Lindsay Erdman* 2/1/21  
 Date

Lindsay Erdman, P.E. & P.L.S.  
 Licensed Professional Land Surveyor  
 Iowa License Number 11442

My license renewal date is December 31, 2022

Pages or sheets covered by this seal: THIS SHEET ONLY

List Corner(s) to be Indexed

Corner(s)	Section	Township	Range
WNW 1/8	12	95N	14W
NW 1/16	12	95N	14W



**ERDMAN**  
**ENGINEERING, P.C.**  
 CIVIL ENGINEERING & LAND SURVEYING  
 Decorah, Iowa