

Prepared by: Erdman Engineering, P.C., 708 Commerce Drive, P.O. Box 246, Decorah, Iowa 52101 (563) 382-4194

United States Public Land Survey Corner Certificate
 of

Land Survey Monuments situated in Section 6, Township 95, Range 13 West of the 5th Principal Meridian in Chickasaw County, Iowa. Previously recorded in does not apply in the county Recorder's Office.

Monument Description and Remarks: This certificate is prepared in accordance with Section 193C of the Code of Iowa. No previous certificate has been filed for this corner location. Chickasaw County Engineer's Reference Ties show that an iron pin has been used previously by the Iowa State Highway Commission as the S ¼ Corner. We made a magnetic locator search of a ±20' diameter area for the iron pin. We did not find the pin as it appears to have been covered by an asphalt overlay. We found a nail with 1 ½" diameter stainless steel washer stamped IDOT. We used the nail and washer as the S ¼ Corner of Section 6, Township 95 North, Range 13 West.

Plan-View

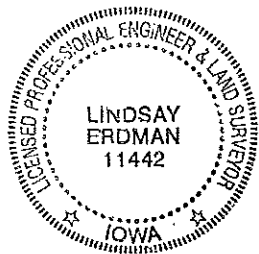
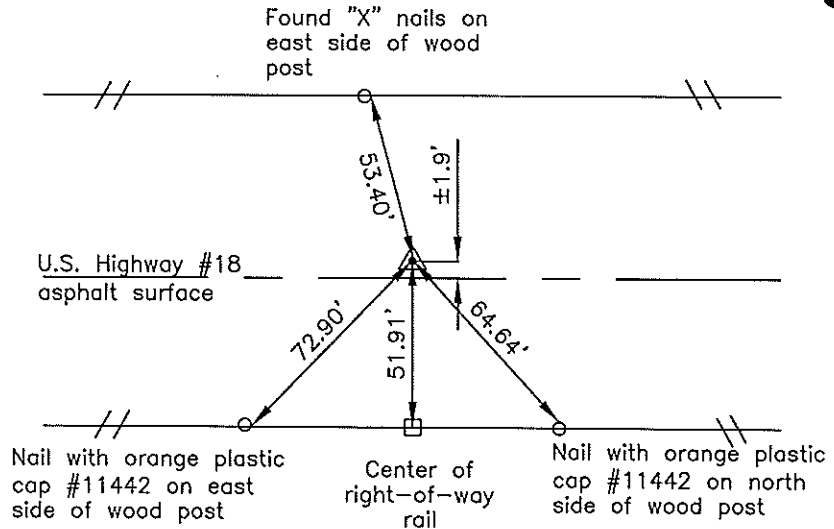
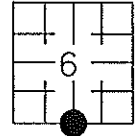

Cor A

I hereby certify that this land surveying document was prepared and the related survey work was performed by me or under my direct personal supervision and that I am a duly licensed Land Surveyor under the laws of the State of Iowa.

Signature Lindsay Erdman
 Lindsay Erdman, P.E. and P.L.S. Iowa License Number 11442

Date: 2/8/08

My license renewal date is December 31, 2008

Corner(s) to be Indexed

Corner	Section	Township	Range
S 1/4	6	95	13