

Prepared by: Erdman Engineering, P.C., 708 Commerce Drive, P.O. Box 246, Decorah, Iowa 52101 (563) 382-4194

**United States Public Land Survey Corner Certificate**  
 of

Land Survey Monuments situated in Section 6, Township 95, Range 13 West of the 5th Principal Meridian in Chickasaw County, Iowa. Previously recorded in does not apply in the county Recorder's Office.

Monument Description and Remarks: This certificate is prepared in accordance with Section 193C of the Code of Iowa. No previous certificate has been filed for this corner location. We found no record of the SSE  $\frac{1}{8}$  Corner being set. We found no evidence of a monument in the field other than a fence line running north and the highway. We found the S  $\frac{1}{4}$  Corner and the SE Corner. We set a Mag-nail with 1  $\frac{1}{2}$ " diameter stainless steel washer #11442 on line and equidistant between the S  $\frac{1}{4}$  Corner and the SE Corner as the SSE  $\frac{1}{8}$  of Section 6, Township 95 North, Range 13 West.

Plan-View

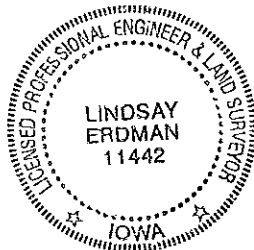
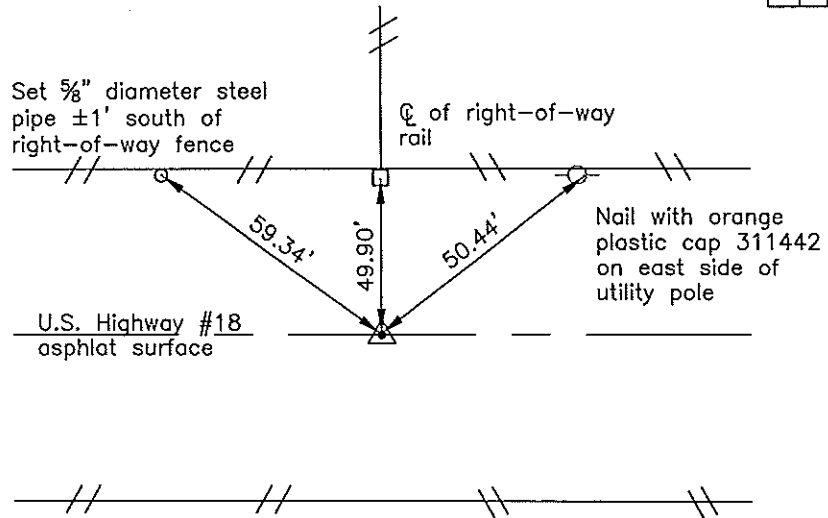
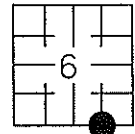

*Cor A1*

I hereby certify that this land surveying document was prepared and the related survey work was performed by me or under my direct personal supervision and that I am a duly licensed Land Surveyor under the laws of the State of Iowa.

Signature *Lindsay Erdman*  
 Lindsay Erdman, P.E. and P.L.S. Iowa License Number 11442

Date: 2/8/08

My license renewal date is December 31, 2008

Corner(s) to be Indexed

Corner	Section	Township	Range
SSE 1/8	6	95	13