



MOHN SURVEYING INC. ROGER R. MOHN 1890 GREAT RIVER ROAD LANSING, IOWA 52151 (563) 538-4067

TIES. DWG Minnowa Construction

SLSI 9-90

UNITED STATES PUBLIC LAND SURVEY CORNER CERTIFICATE

OF

Land Survey Monuments situated in Section 12, Township 96 North, Range 14 West, of the Fifth Principal Meridian, Chickasaw County, Iowa. Previously recorded in Book 163, Page 341 in County Recorder's Office.

(book, page, document number, etc.)

(Show reason for preparing this certificate, the evidence and detailed procedures used in establishing the corner positions and monumentation found or placed.)

Monument Description and Remarks: Corner position was previously monumented with a PK nail. Said PK nail was removed during new bridge construction activities. Re-established the corner position by extending the east line of Section 12 from the SE corner through the E1/4 corner of Section 12 and at the recorded distance as per a plat of survey recorded as Document No. 2002-1746 of Chickasaw Co. Recorder's Office. Checked re-established position with recorded distance to N1/4 corner of Section 12. Cut 'X' in P.C.C. pavement at the computed position.

PLAN - VIEW

(Show a minimum of three reference ties to durable physical objects, relevant monuments and physical conditions that will enable recovery of the corner.)

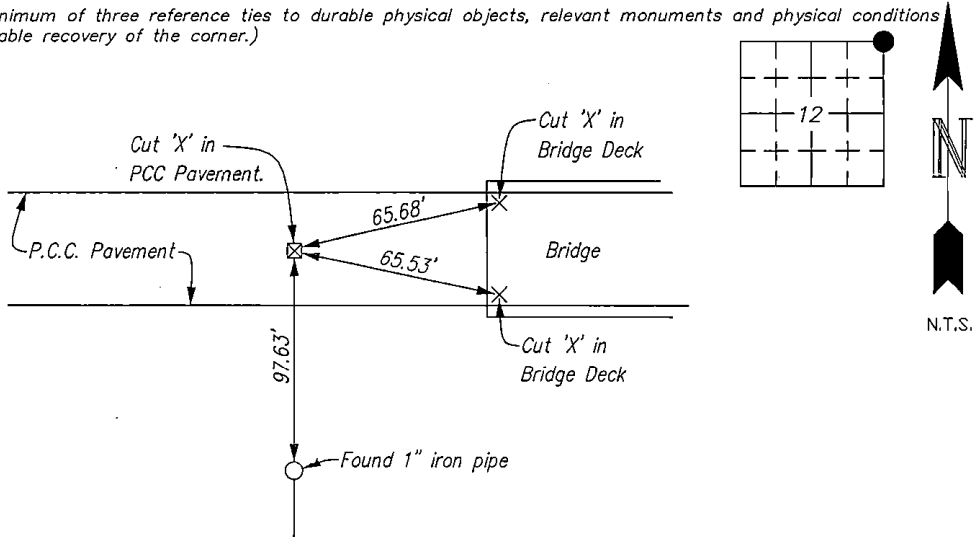

GRID STATE PLANE COORDINATES

N=3885976.35 E=5205158.40

Coordinates are based on the Iowa State Plane Coordinate System North Zone (1401) Horizontal NAD 83 (2011).

I hereby certify that this land surveying document was prepared by me or under my direct personal supervision and that I am a duly Registered Land Surveyor under the laws of the state of Iowa.

Roger R. Mohn 11/22, 2025

ROGER R. MOHN, P.E. & L.S. Iowa Registration No. 10165
 My registration expires December 31, 2026

Corners	List Corners to be Indexed		
	Section	Twp	Range
NE Cor.	12	96N	14W

