

Dec 31/03  
2003 DEC 31 AM 9 18

CINDY MESSERSMITH  
COUNTY RECORDER

Prepared by: Erdman Engineering, P.C., 708 Commerce Drive, P.O. Box 246, Decorah, Iowa 52101 (563) 382-4194

United States Public Land Survey Corner Certificate

of  
Land Survey Monuments situated in Section 13, Township 96, Range 14 West of  
the 5th Principal Meridian in Chickasaw County, Iowa. Previously recorded in  
does not apply in the county Recorder's Office.

Monument Description and Remarks: This certificate is prepared in accordance with Section 193C of the Code of Iowa. No previous certificate has been filed for this corner location. We found no record of the SE 1/6 Corner being set. We found no evidence of a monument in the field other than an existing fence corner with fence lines running north, south, and west. We found the E 1/4 Corner, SE Corner, N 1/4 Corner, SE Corner, W 1/4 Corner, and WSW 1/8 Corner. We computed the location of the ESE 1/8 Corner and the E 1/8 Corner. We set the S 1/8 Corner and the SSE 1/8 Corner. Based on these locations we set a 1/2" diameter steel bar with 2" aluminum cap #11442 at the intersection of the lines from the midpoints of the four sides of the SE 1/4 as the SE 1/6 Corner of Section 13, Township 96 North, Range 14 West.

Plan--View

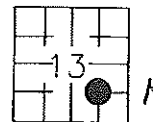
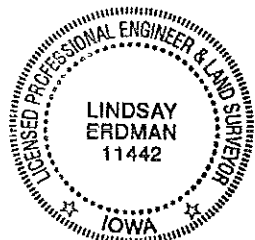

Set 1/2" ø steel bar ±1'  
south of fence line

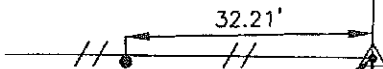

Set 1/2" ø steel bar in  
uncultivated area of field

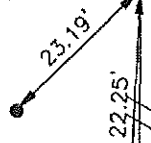

Set 1/2" ø steel bar ±1'  
west of fence line

cor K

I hereby certify that the survey work was completed and this certificate was prepared by me or under my direct supervision and that I am a duly registered land surveyor under the laws of the State of Iowa.

Signature [Signature]  
Lindsay Erdman, P.E. and P.L.S. Iowa License Number 11442

Date: 12/23/03

My license renewal date is December 31, 2004

Corner(s) to be Indexed

Corner	Section	Township	Range
SE 1/16	13	96	14