

Section 14-96-14
As referred to in
Engr. Tic Book.

FILED 2003-3816
RECORDER'S OFFICE
CHICKASAW COUNTY, IOWA
Dec 31/03
2003 DEC 31 AM 9 18

CINDY MESSERSMITH
COUNTY RECORDER

Prepared by: Erdman Engineering, P.C., 708 Commerce Drive, P.O. Box 246, Decorah, Iowa 52101 (563) 382-4194

United States Public Land Survey Corner Certificate
of

Land Survey Monuments situated in Section 13, Township 96, Range 14 West of
the 5th Principal Meridian in Chickasaw County, Iowa. Previously recorded in
does not apply in the county Recorder's Office.

Monument Description and Remarks: This certificate is prepared in accordance with
Section 193C of the Code of Iowa. No previous certificate has been filed for this
corner location. We found no record of the WSW 1/8 Corner being set. We found a 3/4"
diameter steel bar at the approximate centerline of the county road and in line with
the fence lines running east and west. We used the steel bar as the best evidence of
the location for the WSW 1/8 Corner of Section 13, Township 96 North, Range 14 West.

Plan-View

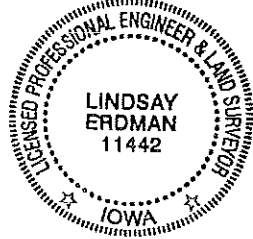

Cor. B' 14-96-14

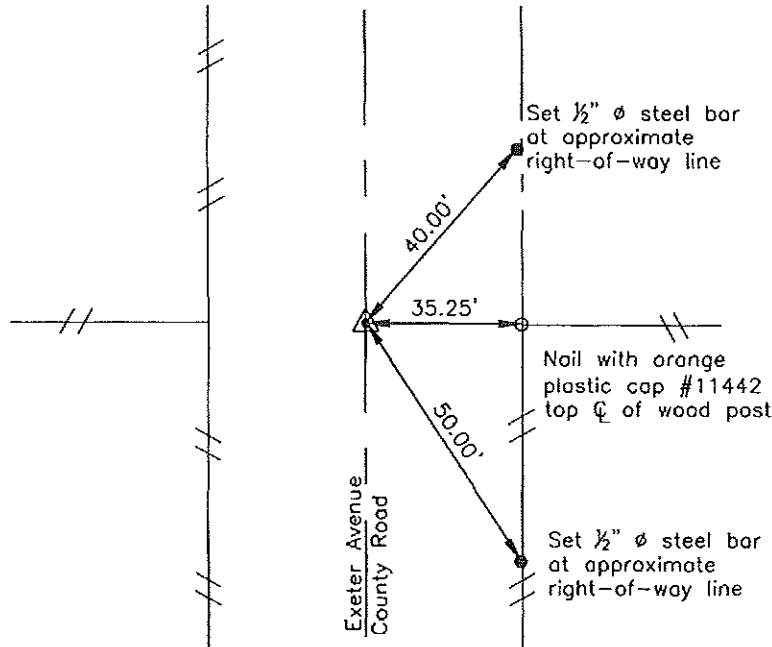
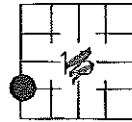

I hereby certify that the survey work was completed
and this certificate was prepared by me or under my
direct supervision and that I am a duly registered
land surveyor under the laws of the State of Iowa.

Signature Lindsay Erdman
Lindsay Erdman, P.E. and P.L.S. Iowa License Number 11442

Date: 12/23/03

My license renewal date is December 31, 2004

Corner(s) to be Indexed

Corner	Section	Township	Range
WSW 1/8	13	96	14