

Scott A. Steinfadt PLS, Ryken Engineering, 711 Park Avenue, Ackley, Iowa 50601 - Ph. 641-847-3273 - Fax 641-847-2303

UNITED STATES PUBLIC LAND SURVEY CORNER CERTIFICATE OF

Land Survey Monuments situated in Section 18, Township 96 North, Range 14 West, of the Fifth Principal Meridian, Chickasaw County, Iowa, Previously recorded in (see below) in County Recorder's Office
SW Corner - Chickasaw County Book 165 Page 353: Center - Chickasaw County Book 165 Page 352: All others - Not Applicable

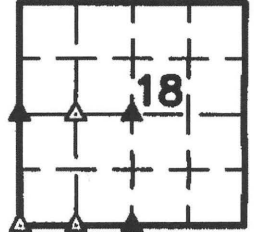

These corners were used for a survey in this section for Rodney L. and Kimberly L. Hinz. Basis of bearing for this corner certificate can be found on the associated plat of survey filed in the Chickasaw County Recorder's Office for this section.

Legend

- | | | |
|---|--|------------------------------------|
| BC = Nail with Bottle Cap | ID = Inside Diameter | R/W = Iron ROW Rail |
| BP = Brace Post | OD = Outside Diameter | SFP = Steel 'T' Post |
| CP = Corner Post | PP = Power Pole | SW = Nail with Square Metal Washer |
| CMP = Corrugated Metal Pipe | PW = Nail with Plastic Washer | TP = Telephone Pedestal |
| CM = 4" Sq Concrete Monument with 1/2" Iron rod in center (tie to roerod) | RCP = Reinforced Concrete Pipe | TW = Nail with Round Metal Washer |
| CX = Cut 'X' | RH = Red Head (Nail in wire) | WFP = Wood Fence Post |
| GP = Gate Post | ROW = Right of Way | X = X Nails |
| | RW = Nail with Reflective Round Washer | |



W¹/₄ Corner

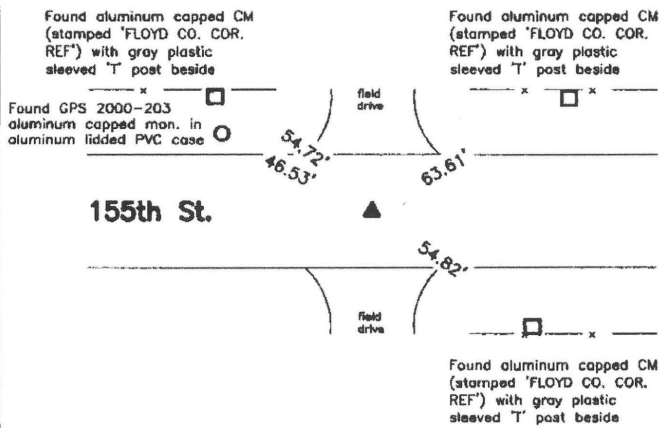

CO ENGR'S RECORD TIES CHICKASAW COUNTY

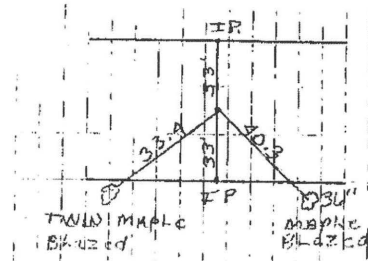

FLOYD COUNTY

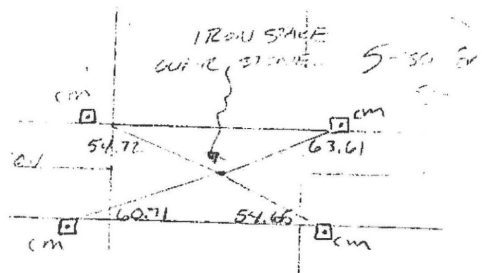

Monument Description, Remarks, and Plan View:

W¹/₄ Corner - History of Corner =

1983, June. 20 - "SET PIN FROM COUNTY TIES" per Floyd County Recorder's Book I.S. 6 Page 20.
1996, Mar. 14 - "REBAR /CAP # 10793" per Floyd County Recorder's Book I.S. 8 Pages 124B, 125B and 126.
1996, Mar. 14 - "REBAR /CAP # 10793" per Chickasaw County Recorder's Book 160 Deeds Page's 200 and 202.
Current Floyd County Engineer's ties indicate that corner is monumented with "IRON STAKE OVER STONE" with ties as shown above.
Current Chickasaw County Engineer's ties indicate that corner is monumented with "Found rock placed as cor. stone" with ties as shown above.

Corner Recovery =

Searched area with a metal detector, excavated a 0.5' x 0.5' deep hole at magnetic reading. Found a 5/8" x 2.5' iron roerod (bent and leaning Southwest) with yellow cap remnants (# not legible), 0.2' deep in apparent centerline of traveled surface of gravel road East-West. Tied out straight portion of roerod and removed. Searched again with a metal detector and found no additional magnetic readings. Probed down roerod hole with a tile probe and hit nothing to 4.5' deep. Replaced roerod in original location and probed on all sides of hole and hit nothing to 4.5' deep. Intersected record County Engineer's ties and found intersection to be South of roerod location. Excavated a 2' x 2' x 2' deep hole around intersection location, probed bottom of hole to 5.5' deep and found no stone. Therefore since roerod had been disturbed, straightened roerod and reset at intersection of County Engineer's ties, 0.4' deep and used it as the correct corner. Monument found matches that of record and record ties are within reason. All ties are plumb distance.

This certificate is being prepared because there are no certificates on file for this corner.



I hereby certify that this land surveying document was prepared and the related survey work was performed by me or under my direct personal supervision and that I am a duly licensed Land Surveyor under the laws of the State of Iowa.

Scott A. Steinfadt PLS.
SCOTT A. STEINFADT, PLS

Date: 12/13/2010 License number: 14677
My license renewal date is December 31, 2010

Pages or sheets covered by this seal: 1, 2, 3

List Corners to be Indexed

Corners	Section	Twp	Range
W ¹ / ₄ Corner	18	T96N	R14W
SW Corner	18	T96N	R14W
NW Cor. E ¹ / ₂ FrSW ¹ / ₄	18	T96N	R14W
SW Cor. E ¹ / ₂ FrSW ¹ / ₄	18	T96N	R14W
Center	18	T96N	R14W
S ¹ / ₄ Corner	18	T96N	R14W