

Chickasaw Co. Recorder
 Cindy Messersmith
 Fee Book 2016-0100
 01/25/2016 @0845AM
 SCC SEC COR CERT
 Book: Page: # Pages: 1
 Total Fees: \$7.00

PREPARED BY : North Star Land Surveyors LLC, 107 Pine Street, New Hampton, IA 50659, Phone : 641-330-6948

UNITED STATES PUBLIC LAND CORNER CERTIFICATE
OF:

Land Survey Monuments situated in Section 22, Township 96 North, Range 14 ~~13~~ West
 of the Fifth Principal Meridian, Chickasaw County, Iowa. Previously recorded in
 document 2005-1123 in Office of County Recorder.

(Book, page, document number, etc.)

(Show reason for preparing this certificate, the evidence and detailed procedures used in establishing the corner positions and monumentation found or placed.)

Monument Description and Remarks :

E 1/4 Corner Section 22 Twp. 96 Rng. 14 W. : Used corner in platting of parcel "J" as shown in document number 2016-0062. Office of Chickasaw County Recorder. Found 3/4" al. capped rebar as shown in document number 2005-1123. Reason for recording: Per Iowa Administrative Code 193C-12.2(2)d., Reference ties in an existing public record are incorrect or missing. Tie Northeast, "stubby on top of CMP" was not found. Set additional ties to perpetuate corner.



PLAN -VIEW

(Show a minimum of three reference ties to durable physical objects, relevant monuments and physical conditions that will enable recovery of the corner.)



Deerfield Township

Cor C. 22-96-14

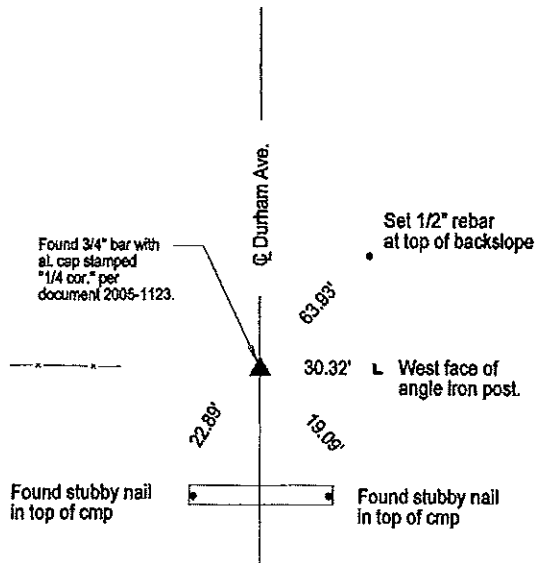

E 1/4 Corner Section 22 Twp. 96 Rng. 14 W.

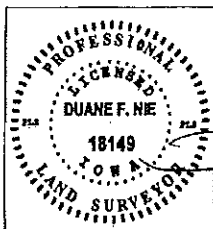

I hereby certify that this land surveying document was prepared and the related survey work was performed by me or under my direct personal supervision and that I am a duly Licensed Land Surveyor under the laws of the State of IOWA.

Duane F. Nie License number 18149 Date *January 25, 2016*
 My license renewal date is December 31, 2016
 Pages or sheets covered by this seal. This page only

List Corners to be Indexed			
Corner	Section	Township	Range
E 1/4 Cor.	22	96	14

Lee O. Gallentine LS, Ryken Engineering, 915 Seneca St., Webster City, IA. 50596 - Ph. 515-832-1876 - Fax 515-832-1932

UNITED STATES PUBLIC LAND SURVEY CORNER CERTIFICATE

Land Survey Monuments situated in Section 22, Township 96 North, Range 14 West, of the Fifth Principal Meridian, Chickasaw County, Iowa,
 Previously recorded in Not Applicable in County Recorder's Office

(Show reason for preparing this certificate, the evidence and detailed procedures used in establishing the corner positions and monumentation found or set.)

Monument Description and Remarks:

E¼ Cor - History of Corner - Current Co Engr's records indicate that corner is monumented with 'Limestone' with ties as shown below.

Corner Recovery - Searched area with metal detector and found 1" I.D. x 2.1' iron Pipe 2.2' deep at 1.0' +/- E of centerline of gravel road N-S, in-line with steel corner post W, and 1.0' +/- N of steel corner post E. Pipe found is only monument available and fits existing corner post evidence well. Therefore, set 3/4" ø x 24" Alum Capped iron rod (#15745) stamped as shown below in pipe to raise up monumentation and used it as the correct corner. Rod is 0.4' deep. All ties are plumb distance unless indicated otherwise.

This certificate is being prepared because there are no certificates on file for this corner and this corner was used for a survey in this section for George L and Linda Ann Huegel and Elam Z. and Mabel M. Martin.

Plan View

(Show a minimum of three reference ties to durable physical objects, relevant monuments, and physical conditions that will enable recovery of the corner.)

E¼ Cor

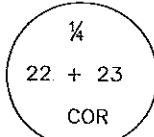
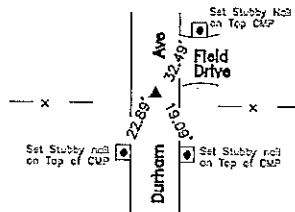

Monument Detail

Cor. C

Legend

- BC = Nail w/ Bottle Cap
- BP = Brace Post
- CP = Corner Post
- CM = 4" Sq Concrete Monument w/ 1/2" ø Iron rod in center (tie to rod)
- CX = Cut X
- GP = Gate Post
- GPW = Nail w/ Green Plastic Washer
- PP = Power Pole
- RH = Red Head (Nail in wire)
- SFP = Steel Fence Post
- RW = Nail w/ Reflective Round Washer
- R/W = Iron ROW Nail
- SM = Yellow Plastic Survey Marker
- SW = Nail w/ Square Metal Washer
- TP = Telephone Pedestal
- TW = Nail w/ Round Metal Washer
- WFP = Wood Fence Post
- X = X Nails



CO ENGR'S RECORD TIES

	Limestone	
Large	24.2	Large
check post	23.6	check post
COR. C		

C. Limestone 1925 I.W.P. grade hmc

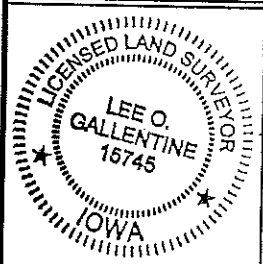

I hereby certify that this land surveying document was prepared and the related survey work was performed by me or under my direct personal supervision and that I am a duly licensed Land Surveyor under the laws of the State of Iowa.

Lee O. Gallentine PLS

LEE O. GALLENTINE, LS
 Date: May 26, 2005 license number: 15745
 My license renewal date is December 31, 2006

Pages or sheets covered by this seal: 1

<u>List Corners to be Indexed</u>			
Corners	Section	Twp	Range
E¼ Cor	22	T96N	R14W