



Prepared by: Erdman Engineering, P.C., 708 Commerce Drive, P.O. Box 246, Decorah, Iowa, (563)382-4194

UNITED STATES PUBLIC LAND SURVEY CORNER CERTIFICATE
 OF

Land Survey Monuments situated in Section 24, Township 96 North, Range 14 West, of
 the Fifth Principal Meridian, Chickasaw County, Iowa, Previously recorded in does not apply in the
 County Recorder's Office.

Monument Description and Remarks:

This certificate is prepared in accordance with Section 355.11 of the Code of Iowa. No previous certificates have been filed for these corner locations.

NE 1/16 Corner: We found no record of the NE 1/16 Corner being set. We found no evidence of a monument in the field other than an existing fence line corner with fence lines running east, west and north. We found the NNE 1/8 and E 1/4 Corner. We set the Center Section and the ENE 1/8 Corner. We computed the location of the NE 1/16 at the intersection of the lines from the midpoints of the four sides of the Northeast Quarter. This location was approximately ±8' east of the fence corner. We used the fence corner as the NE 1/16 Corner of Section 24, Township 96 North, Range 14 West. We set a 1/2" diameter steel bar with 1 1/2" aluminum cap #11442 on south side of the post.

ENE 1/8 Corner: We found no record of the ENE 1/8 Corner being set. We found no evidence of a monument in the field other than an existing fence line running east and north. We found the NE Corner and E 1/4 Corner. We computed the location of the ENE 1/8 Corner online and midway between the E 1/4 and the NE Corner. This location was approximately ±5' north of the intersection of the fence lines. We set a 1/2" diameter steel bar with 1 1/2" aluminum cap #11442 on line between the E 1/4 Corner and the NE Corner and in line with east-west fence line as the ENE 1/8 Corner of Section 24, Township 96 North, Range 14 West.

PLAN-VIEW

(NOT TO SCALE)

NE 1/16 CORNER

Set 1/2" diameter steel bar with 1 1/2" aluminum cap #11442

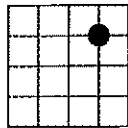

SECTION 24

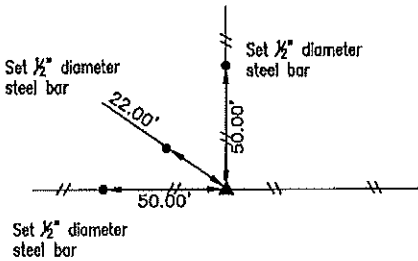

Cor 2
 24-96-14

ENE 1/8 CORNER

Set 1/2" diameter steel bar with 1 1/2" aluminum cap #11442

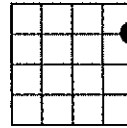

SECTION 24

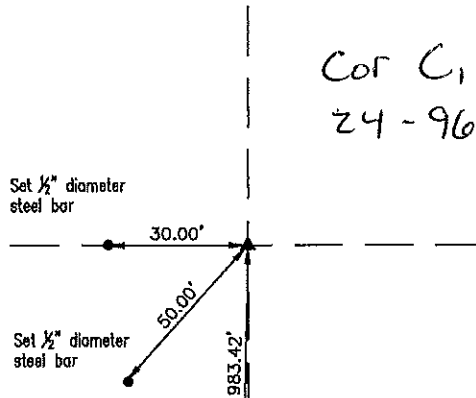

Cor C,
 24-96-14
 Nail with orange plastic cap #11442 on west side of wood post

I hereby certify that this land surveying document was prepared and the related survey work was performed by me or under my direct personal supervision and that I am a duly licensed Land Surveyor under the laws of the State of Iowa.

Lindsay Erdman 3/18/19
 Date

Lindsay Erdman, P.E. & P.L.S.
 Licensed Professional Land Surveyor
 Iowa License Number 11442
 My License renewal date is December 31, 2020

Pages or sheets covered by this seal: THIS SHEET ONLY

List Corner(s) to be Indexed

Corner(s)	Section	Township	Range
NE 1/16	24	96N	14W
ENE 1/8	24	96N	14W

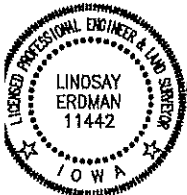

ERDMAN
ENGINEERING, P.C.
 CIVIL ENGINEERING & LAND SURVEYING
 Decorah, Iowa