

Prepared by: Erdman Engineering, P.C., 708 Commerce Drive, P.O. Box 246, Decorah, Iowa, (563)382-4194

UNITED STATES PUBLIC LAND SURVEY CORNER CERTIFICATE

Land Survey Monuments situated in Section 23 OF 26, Township 96 North, Range 14 West, of the Fifth Principal Meridian, Chickasaw County, Iowa, Previously recorded in does not apply in the County Recorder's Office.

Monument Description and Remarks:

This certificate is prepared in accordance with Section 355.11 of the Code of Iowa. No previous certificates have been filed for these corner locations.

N 1/4 Corner: Chickasaw County Engineer's Reference ties show that an iron pin had been set on the high point of a limestone in 1956 and the pin was raised and tied in 1958. We found a steel fence post that had been used previously as a tie marker. From this remaining tie we made a metal locator search for the iron pin. We did not find the pin as it appears to have been removed when a road culvert to the east had been replaced. We set a 1/2" diameter steel bar with 1 1/2" aluminum cap #11442 from the remaining tie to the north and the S 1/4 Corner as the N 1/4 corner of Section 26, Township 96 North, Range 14 West.

PLAN-VIEW
(NOT TO SCALE)

N 1/4 CORNER
 Set 1/2" diameter steel bar with 1 1/2" aluminum cap #11442

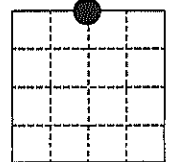

SECTION 26

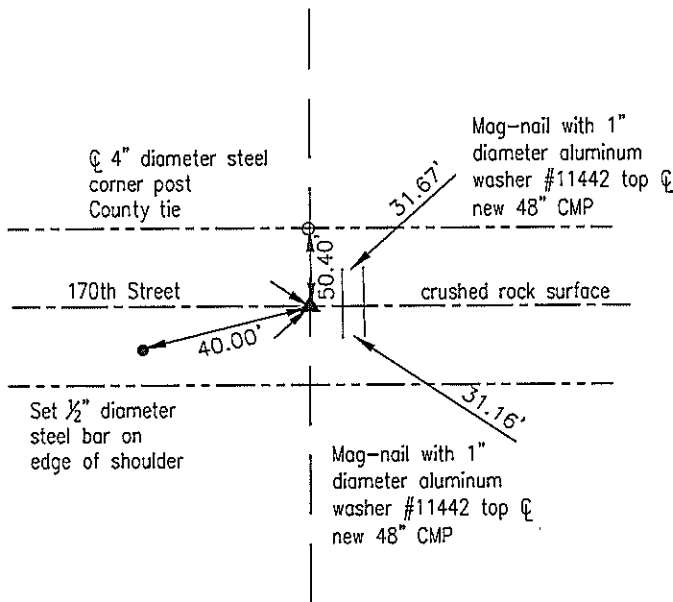

Cor A
 23-96-14

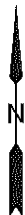

I hereby certify that this land surveying document was prepared and the related survey work was performed by me or under my direct personal supervision and that I am a duly licensed Land Surveyor under the laws of the State of Iowa.

Lindsay Erdman 1/30/15
 Lindsay Erdman, P.E. & P.L.S. Date
 Licensed Professional Land Surveyor
 Iowa License Number 11442
 My License renewal date is December 31, 2016
 Pages or sheets covered by this seal: THIS SHEET ONLY

List Corner(s) to be Indexed

Corner(s)	Section	Township	Range
N 1/4	26	96	14

ERDMAN ENGINEERING, P.C.

CIVIL ENGINEERING & LAND SURVEYING