

Prepared by: Erdman Engineering, P.C., 708 Commerce Drive, P.O. Box 246, Decorah, Iowa 52101 (563) 382-4194

United States Public Land Survey Corner Certificate
 of

Land Survey Monuments situated in Section 9, Township 96, Range 14 West of the 5th Principal Meridian in Chickasaw County, Iowa. Previously recorded in does not apply in the county Recorder's Office.

Monument Description and Remarks: This certificate is prepared in accordance with Section 355.11 of the Code of Iowa. No previous certificate has been filed for this corner location. We found no record of the Center Section being set. We found no evidence of a monument in the field other than an existing fence line running east and west. We found the N 1/4 Corner, NE Corner, SE Corner, and the SW Corner. We computed the location of the W 1/4 Corner on line and midway between the SW Corner and the NW Corner. We set the E 1/4 Corner at the center of the county road right-of-way and in line with the fence line running west. We set the S 1/4 Corner at an existing fence corner. We computed the location of the Center Section at the intersection of the lines from the quarter corners. This location was ±3' north of the fence line. We set a 1/2" diameter steel bar with 1 1/2" aluminum cap #11442 online between the N 1/4 Corner and the S 1/4 Corner and in the existing east-west fence line as the Center of section 9, Township 96 North, Range 14 West.

Plan-View

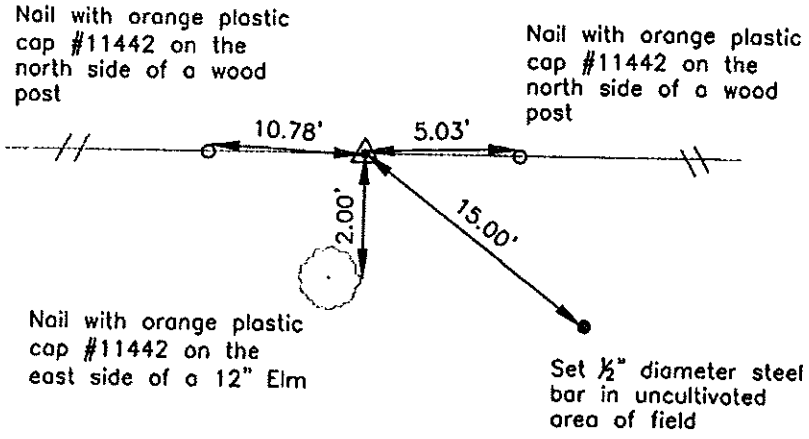
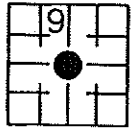

cor. O
 9-96-14

I hereby certify that this land surveying document was prepared and the related survey work was performed by me or under my direct personal supervision and that I am a duly licensed Land Surveyor under the laws of the State of Iowa.

Signature: Lindsay Erdman
 Lindsay Erdman, P.E. and P.L.S. Iowa License Number 11442

Date: 6/11/12

My license renewal date is December 31, 2012

Corner(s) to be Indexed

Corner	Section	Township	Range
C.S.	9	96	14