

Section 11-94-12
As referred to in
Engg Tie Book

DOCUMENT No. **01423** FILED FOR RECORD THE 26th DAY OF January, 1998 AT 8:30 O'CLOCK A.M. BOOK 166 Deeds PAGE 318 STATE OF IOWA, CHICKASAW COUNTY, Lindsay Erdman Recorder
RECORDING FEE \$ 6.00 BY LETITIA H. ROSS Deputy
TRANSFER FEE \$ _____

Prepared by: Erdman Engineering P.C. 708 Commerce Drive, P.O. Box 246, Decorah Iowa, 52101
Phone (319)382-4194, Fax (319)382-3623

United States Public Land Survey Corner Certificate
// of

Land Survey Monuments situated in Section 12 Township 94 Range 12 of the Fifth Principle Meridian, Chickasaw County, Iowa. Previously recorded in does not apply in County Recorders Office.

(Show reason for preparing this certificate, the evidence and detailed procedures used in establishing the corner positions and monumentation found or placed.)

Monument Description and Remarks: This certificate is prepared in accordance with Section 355.11 of the 1995 Code of Iowa. No previous certificate has been filed for this corner location. Based on a plot from book 120 page 448 in the Chickasaw County Recorder's Office we set the WSW 1/8 corner from a platted dimension of 1319.0' from the from the SW 1/4 to the WSW 1/8 corner on line between the SW 1/4 and the W 1/4 corners. We set a 1/2" bar with cap RLS #11442 at the WSW 1/8 corner of section 12-94-12.

Plan-View
(Show a minimum of three reference ties to durable physical objects, relevant monuments and physical conditions that will enable recovery of the corner.)

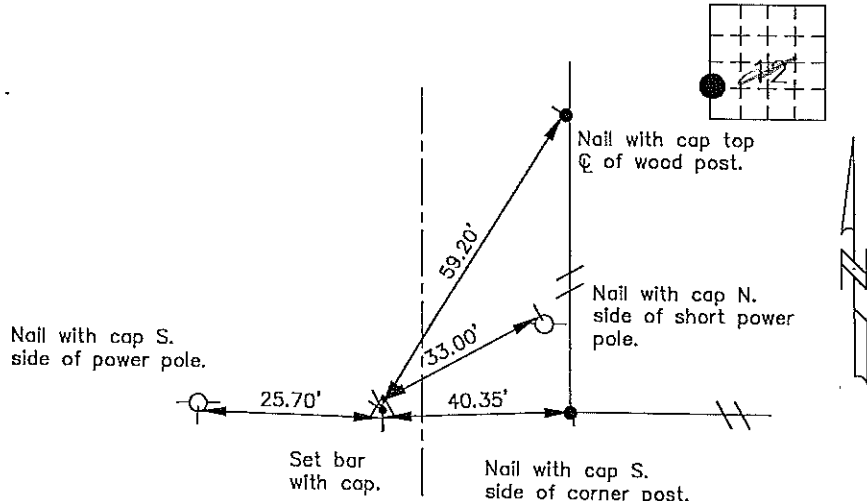

Cor B1
11-94-12

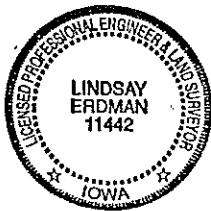

I hereby certify that the survey work was completed and this certificate was prepared by me or under my direct supervision and that I am a duly registered land surveyor under the laws of the State of Iowa.

Signature Lindsay Erdman
Lindsay Erdman, P.E. and L.S.
Date: 1/21/98 Reg. No. 11442

My license renewal date is December 31, 1998

Corners	List Corners to be Indexed		
	Section	Twp.	Range
WSW 1/8	12	94	12