

CINDY MESSERSMITH
 COUNTY RECORDER

Prepared by: Erdman Engineering, P.C., 708 Commerce Drive, P.O. Box 246, Decorah, Iowa 52101 (563) 382-4194

United States Public Land Survey Corner Certificate
 of

Land Survey Monuments situated in Section 31, Township 97, Range 12 West of the 5th Principal Meridian in Chickasaw County, Iowa. Previously recorded in does not apply in the county Recorder's Office.

Monument Description and Remarks: This certificate is prepared in accordance with Section 193C of the Code of Iowa. No previous certificate has been filed for this corner location. We found no record of the SSW 1/8 Corner as being set. We found no evidence of a monument in the field other than the county road and a fence line running north. We found the SW Corner and the S 1/4 Corner. County records show a distance of 15.76 chains (1040.16') from the SW Corner to the SSW 1/8 Corner. We computed this location. It fell approximately 145' west of the existing line of occupation fence. We used the fence as the best remaining evidence of the location of the SSW 1/8 Corner. We set a 1/2" diameter steel bar with 1 1/2" aluminum cap #11442 on line between the SW Corner and the S 1/4 Corner and in line with the occupation fence running north as the SSW 1/8 Corner of Section 31, Township 97 North, Range 12 West. This placed the monument at 1187.45 west of the S 1/4 which was a much better match than the 15.76 chain (1040.16') dimension as there did not appear to be a good reason for the E 1/2 Fractional SW 1/4 to be short by 147.29'.

Plan-View

Cor F'

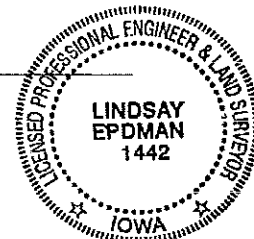
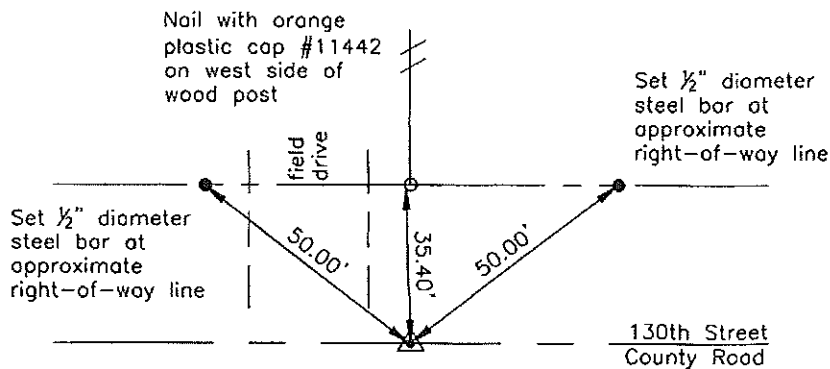
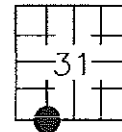

I hereby certify that the survey work was completed and this certificate was prepared by me or under my direct supervision and that I am a duly registered land surveyor under the laws of the State of Iowa.

Signature Lindsay Erdman
 Lindsay Erdman, P.E. and P.L.S. Iowa License Number 11442

Date: 12/16/04

My license renewal date is December 31, 2004

Corner(s) to be Indexed

Corner	Section	Township	Range
SSW 1/8	31	97	12