

Prepared by: Erdman Engineering, P.C., 708 Commerce Drive, P.O. Box 246, Decorah, Iowa 52101 (563) 382-4194

United States Public Land Survey Corner Certificate
 of

Land Survey Monuments situated in Section 16, Township 95 North, Range 12 West of the 5th Principal Meridian in Chickasaw County, Iowa. Previously recorded in does not apply in the county Recorder's Office.

Monument Description and Remarks: This certificate is prepared in accordance with Section 193C of the Code of Iowa. No previous certificate has been filed for this corner location. We searched Chickasaw County records and found no record of the E $\frac{1}{8}$ Corner being set. We found no evidence of a monument in the field other than a county road (Odessa Avenue). We found the Center Section and E $\frac{1}{4}$ Corner. We set a $\frac{1}{2}$ " diameter steel bar with 1 $\frac{1}{4}$ " aluminum cap #11442 on line and equidistant between the E $\frac{1}{4}$ Corner and Center Section as the E $\frac{1}{8}$ Corner of Section 16, Township 95 North, Range 12 West. This location was approximately 3' west of the centerline of Odessa Avenue.

Plan-View

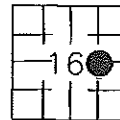
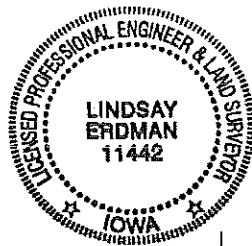

COR. Q

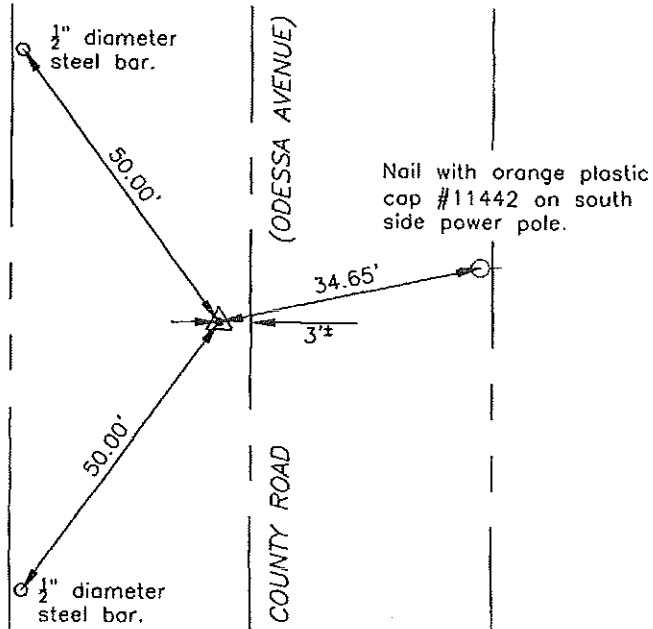

I hereby certify that the survey work was completed and this certificate was prepared by me or under my direct supervision and that I am a duly registered land surveyor under the laws of the State of Iowa.

Signature: Lindsay Erdman
 Lindsay Erdman, P.E. and P.L.S.
 Date: 2/18/04 Reg. No. 11442

My license renewal date is December 31, 2004

Corner(s) to be Indexed

Corner	Section	Township	Range
E 1/8	16	95N	12W