

UNITED STATES PUBLIC LAND SURVEY CORNER CERTIFICATE

OF

Land Survey Monuments situated in Section 18, Township 95 North, Range 12 West of the Fifth Principal Meridian, CHICKASAW County, Iowa  
 Previously recorded in none in County Recorder's Office.  
(book, page, document number, etc.)

(Show reason for preparing this certificate, the evidence and detailed procedures used in establishing the corner positions and monumentation found or placed.)

Monument Description and Remarks: SE Corner SW 1/4 - NE 1/4 Section 18 T95N R12W  
Set 1/2"Ø rebar w/2"Ø aluminum cap LS 7060 by extending a line from the NW Co-  
NE 1/4 - NE 1/4 through the centerline of 4th Avenue and intersecting the E/W  
1/4 Section Line between the E 1/4 corner and the Center of Section 18.

PLAN - VIEW

Project Number 00054  
 FR. 460 PA. 44--

(Show a minimum of three reference ties to DURABLE physical objects, relevant monuments and physical conditions that will enable recovery of the corner.)

Sec. 18  
 T95N  
 R12W

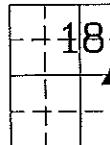

New Hamptc

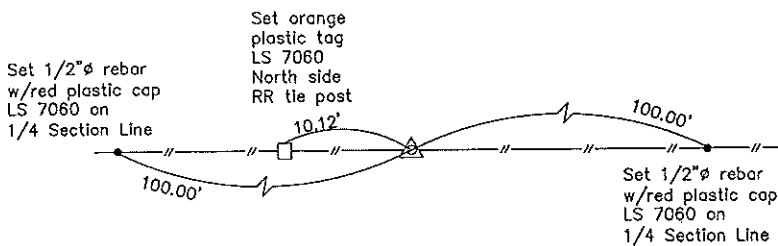

Cor Q

SE Corner SW 1/4 - NE 1/4 Section 18 T95N R12W  
 Set 1/2"Ø rebar w/2"Ø aluminum cap LS 7060

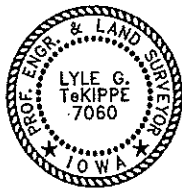

I hereby certify that this land surveying document was prepared and the related survey work was performed by me or under my direct personal supervision and that I am a duly licensed Land Surveyor under the laws of the State of Iowa.

*Lyle G. TeKippe* 4-20-00  
 Lyle G. TeKippe Date

License number 7060  
 My license renewal date is December 31, 2000.  
 Sheets covered by this seal: Individual

List Corners to be Indexed			
Corners	Section	Twp.	Range
SE-SW-NE	18	95N	12W

Entered 4-26-00

2000-07/b

County Recorder's Copy