

Section 13-94-13  
As referred to in  
Engr. Tie Book

SLS19-90

UNITED STATES PUBLIC LAND SURVEY CORNER CERTIFICATE

Land Survey Monuments situated in Section 24 OF 13, Township 94N, Range 13W of the Fifth Principal Meridian, CHICKASAW County, Iowa.  
Previously recorded in (NONE) in County Recorder's Office.  
(book, page, document number, etc.)

(Show reason for preparing this certificate, the evidence and detailed procedures used in establishing the corner positions and monumentation found or placed.)

Monument Description and Remarks: FOUND IRON PIPE WITH IDOT ALUMINUM CAP 14" DEEP, RAISED WITH 1/2" Ø REBAR WITH CAP.

PLAN - VIEW

(Show a minimum of three reference ties to durable physical objects, relevant monuments and physical conditions that will enable recovery of the corner.)

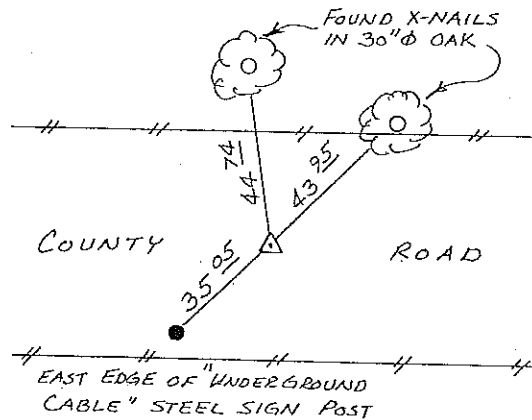
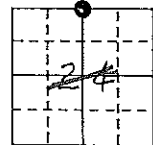

Cor A  
13-94-13

N<sup>1</sup>/<sub>4</sub> CORNER SECTION 24-T94N-R13W

I hereby certify that the survey work was completed and this certificate was prepared by me or under my direct personal supervision and that I am a duly registered land surveyor under the laws of the state of Iowa.

Signature: Lyle G. TeKippe  
Name typed or printed: Lyle G. TeKippe

Date: 4-10-92 Reg. No. 7060

Corners	Section	Twp	Range
N <sup>1</sup> / <sub>4</sub>	24	94N	13W

SEAL

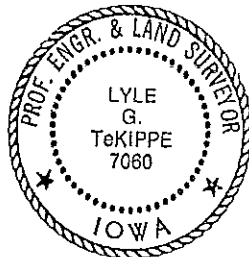

*C*  
*Placed in tie book 4/13/92*

149-264

"County Engineer's Copy"