

Section 25-96-12
As referred to in
Engr. The Book

FILED 2004-0834

RECORDER'S OFFICE
CHICKASAW COUNTY, IOWA

Sec 2/100
2004 APR 12 AM 9 36

CINDY MESSERSMITH
COUNTY RECORDER

Prepared by: Erdman Engineering, P.C., 708 Commerce Drive, P.O. Box 246, Decorah, Iowa 52101 (563) 382-4194

United States Public Land Survey Corner Certificate
of

Land Survey Monuments situated in Section 30, Township 96, Range 11 West of
the 5th Principal Meridian in Chickasaw County, Iowa. Previously recorded in
does not apply in the county Recorder's Office.

Monument Description and Remarks: This certificate is prepared in accordance with
Section 193C of the Code of Iowa. No previous certificate has been filed for this
corner location. We found no record of the W $\frac{1}{4}$ Corner being set. We found no evidence
of a monument in the field other than an existing fence corner with fence lines running
north, south, and east. We used the fence corner as the best remaining evidence of
the location of the W $\frac{1}{4}$ Corner of Section 30, Township 96 North, Range 11 West and
set a $\frac{3}{4}$ " diameter steel bar with 2" aluminum cap #11442 on the west side of the
corner post.

Plan-View

C 25-96-12

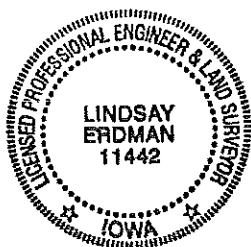
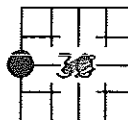

Nail with orange
plastic cap #11442
on north side of
fence post

Nail with orange
plastic cap #11442
on east side of
fence post

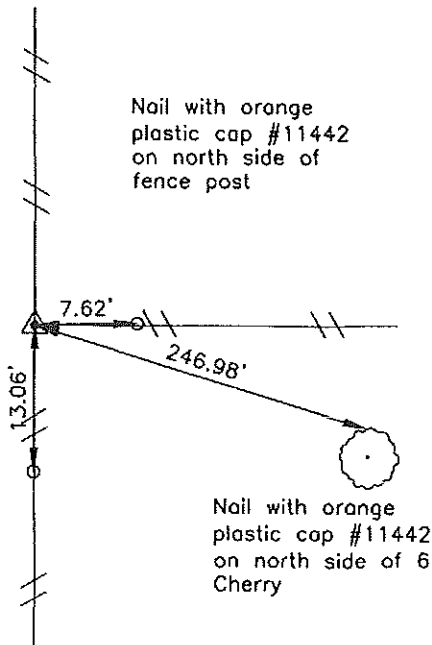

I hereby certify that the survey work was completed
and this certificate was prepared by me or under my
direct supervision and that I am a duly registered
land surveyor under the laws of the State of Iowa.

Signature Lindsay Erdman
Lindsay Erdman, P.E. and P.L.S., Iowa License Number 11442

Date: 4/8/04

My license renewal date is December 31, 2004

Corner(s) to be Indexed

Corner	Section	Township	Range
W $\frac{1}{4}$	30	96	11