

Instrument #: 2022-1889  
 10/14/2022 03:34:21 PM Total Pages: 1  
 SCC SECTION CORNER CERTIFICATES  
 Recording Fee: \$ 7.00  
 Shirley Troyna, Recorder, Chickasaw County Iowa



Prepared by: Kyle A. Johnson Address: 1900 MEDICAL ARTS AVE S, SUITE 100 SARTELL, MN Phone: 1-888-937-5150

UNITED STATES PUBLIC LAND SURVEY CORNER CERTIFICATE FOR

Land survey monuments situated in Section 21, Township 96 NORTH  
13 WEST, of the Fifth Principal Meridian, CHICKASAW County, Iowa.

Previously Recorded in \_\_\_\_\_ in County Recorder's Office.

(Show reason for preparing this certificate, the evidence and detailed procedures used in establishing the corner positions and monumentation found or placed.)

MONUMENT DESCRIPTION AND REMARKS:

**NORTHWEST CORNER:** Westwood Professional Services searched the area and found 2" aluminum cap stamped 19211, which is consistent with the corner certificate filed in Book 2011-0225 by Kirk Reick, LS 19211. Did not recover any record ties. Set additional ties and accepting as the best available evidence of the corner position. Filing due to missing ties.

**NORTH QUARTER:** Westwood Professional Services searched the area and found no monuments for the corner location. The GLO single proportion position lands +/-65 ft. NW of a West/South fence intersection. The Chickasaw County Engineers tie book shows a position 40.56 chains from the NW of Section 21 and 38.45 chains from the NE of Section 21. This proportioned distance lands +/-8 ft. east of the West/South fence intersection, which is a common occupation difference through out the county when the tie books do not list a monument in place, as in this situation. Holding the fence intersection as the best available evidence of the corner position, which agrees with occupation lines in Sections 16 and 21. Set a 1/2" rebar with orange LS 25725 cap. Filing due to no found monument.

PLAN - VIEW

(Show a minimum of three reference ties to durable physical objects, relevant monuments and physical conditions that will enable recovery of the corner.)

Cor. B 17-96-13  
 NORTH QUARTER

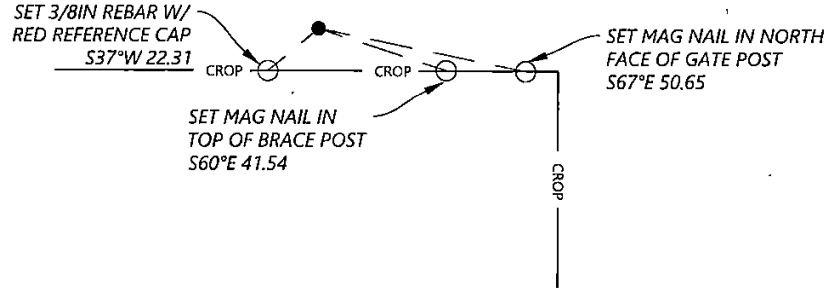

Cor. A 16-96-13  
 NORTHWEST CORNER

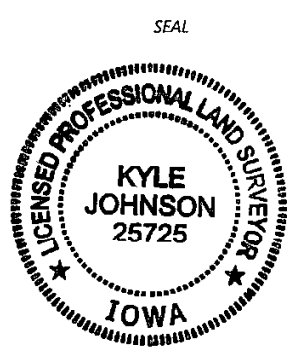
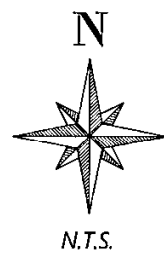
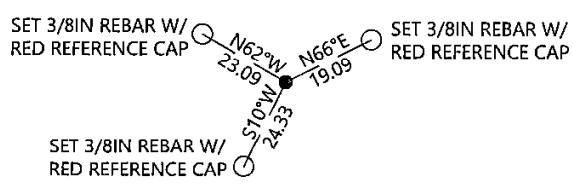

I hereby certify that this land surveying document was prepared and the related survey work was performed by me or under my direct personal supervision and that I am a duly licensed Land Surveyor under the laws of the state of Iowa.

Kyle Johnson 10/14/2022  
 Signature Date

Typed/Printed Name: Kyle A. Johnson

License Number: 25725

My license renewal date is December 31, 2022

Pages or sheets covered by this seal: THIS SHEET

Corners to be Indexed

Corners	Section	Twp.	Range
NW	21	96	13
NQ	21	96	13