

2001 MAY 16 AM 10:07
fee 6.00

CINDY MESSERSMITH
 CHICKASAW CO. RECORDER

Prepared by: Erdman Engineering, P.C. 708 Commerce Drive, P.O. Box 246 Decorah, Iowa 52101, (319)382-4194

United States Public Land Survey Corner Certificate
 of

Land Survey Monuments situated in Section 31, Township 96, Range 13 West of the 5th Principal Meridian in Chickasaw County, Iowa. Previously recorded in does not apply in the county Recorder's Office.

Monument Description and Remarks: This certificate is prepared in accordance with Section 193C of the Code of Iowa. No previous certificate has been filed for this corner location. Based on Chickasaw County Engineer's Reference Ties we searched for the tie markers previously set. We did not find any as they appear to have been removed by farming operation. County Engineer's Reference Ties show a stone at the center of the 66' wide right-of-way previously set at the N 1/4 Corner. We dug a 2' deep hole at the center of the 66' wide right-of-way in line with the fence line running south. We did not find the stone. Based on this we set a 1/2" diameter steel bar with yellow plastic cap #11442 at the center of the 66' wide right-of-way, in line with the fence line running south as the N 1/4 Corner of Section 31, Township 96 North, Range 13 West.

Plan-View

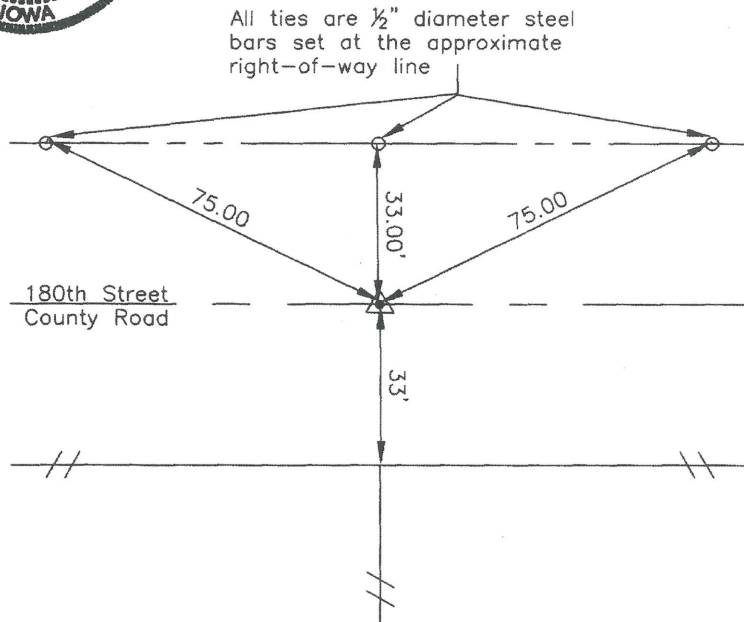
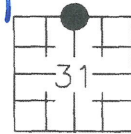

I hereby certify that the survey work was completed and this certificate was prepared by me or under my direct supervision and that I am a duly registered land surveyor under the laws of the State of Iowa.

Signature

Lindsay Erdman
 Lindsay Erdman, P.E. and L.S.

Date: 5/14/01 Reg. No. 11442

My license renewal date is December 31, 2002

Corner(s) to be Indexed

Corner	Section	Township	Range
N 1/4	31	96	13