

Prepared by: Erdman Engineering, P.C., 708 Commerce Drive, P.O. Box 246, Decorah, Iowa 52101 (563) 382-4194

United States Public Land Survey Corner Certificate
 of

Land Survey Monuments situated in Section 30, Township 96, Range 13 West of the 5th Principal Meridian in Chickasaw County, Iowa. Previously recorded in does not apply in the county Recorder's Office.

Monument Description and Remarks: This certificate is prepared in accordance with Section 193C of the Code of Iowa. No previous certificate has been filed for this corner location. We found no record of the SSE $\frac{1}{8}$ Corner. We found no evidence of a monument in the field other than the county road. We found the S $\frac{1}{4}$ Corner and reset the SE Corner from ties. We found the SE $\frac{1}{6}$ Corner and the NE Corner of Lot 3 in the W $\frac{1}{2}$ of the SE $\frac{1}{4}$. We set a $\frac{1}{2}$ " diameter steel bar with 1 $\frac{1}{2}$ " aluminum cap #11442 on-line between the S $\frac{1}{4}$ Corner and the SE at the intersection with the extension of the line from the SE $\frac{1}{6}$ Corner through the NE Corner of Lot 3 Corner as the SSE $\frac{1}{8}$ Corner of Section 30, Township 96 North, Range 13 West.

Plan-View

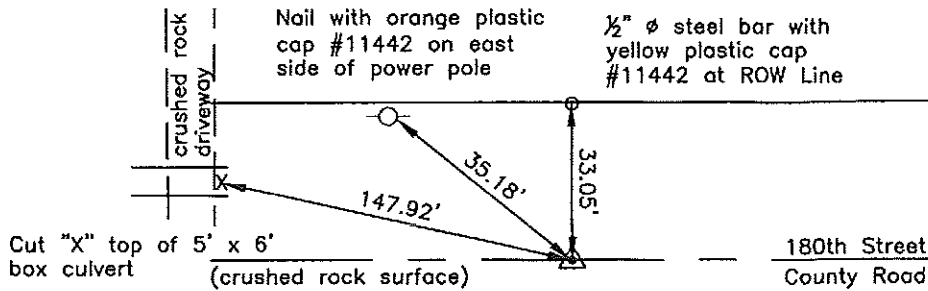
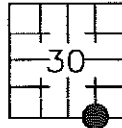

Cor A1

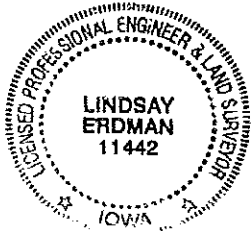

I hereby certify that this land surveying document was prepared and the related survey work was performed by me or under my direct personal supervision and that I am a duly licensed Land Surveyor under the laws of the State of Iowa.

Signature Lindsay Erdman
 Lindsay Erdman, P.E. and P.L.S. Iowa License Number 11442

Date: 3/22/07

My license renewal date is December 31, 2008

Corner(s) to be Indexed

Corner	Section	Township	Range
SSE 1/8	30	96	13